

# COUNTY OF SUFFOLK



STEVEN BELLONE  
SUFFOLK COUNTY EXECUTIVE

DEPARTMENT OF ECONOMIC DEVELOPMENT AND PLANNING  
DIVISION OF PLANNING AND ENVIRONMENT

COUNCIL ON ENVIRONMENTAL QUALITY

GLORIA RUSSO  
CHAIRPERSON  
CEQ

## **NOTICE OF PUBLIC MEETING**

**Notice is hereby given that the Council on Environmental Quality will convene a regular public meeting at 9:30 a.m. on Wednesday April 17<sup>th</sup>, 2013 in the Arthur Kunz Library, H. Lee Dennison Building, Fourth Floor, Veterans Memorial Highway, Hauppauge, NY 11788. Pursuant to the Citizens Public Participation Act, all citizens are invited to submit testimony, either orally or in writing at the meeting. Written comments can also be submitted prior to the meeting to the attention of:**

**Andrew P. Freleng, Chief Planner  
Council on Environmental Quality  
Suffolk County Planning Department  
P.O. Box 6100  
Hauppauge, NY 11788  
631-853-5191**

**Council of Environmental Quality  
Gloria Russo, Chairperson**

# COUNTY OF SUFFOLK



STEVEN BELLONE  
COUNTY EXECUTIVE

DEPARTMENT OF ECONOMIC DEVELOPMENT AND PLANNING  
DIVISION OF PLANNING AND ENVIRONMENT  
COUNCIL ON ENVIRONMENTAL QUALITY

GLORIA RUSSO  
CHAIRPERSON  
CEQ

## AGENDA

### MEETING NOTIFICATION

**Wednesday, April 17<sup>th</sup>, 2013 9:30 a.m.**

**Arthur Kunz Library  
H. Lee Dennison Bldg. - 4<sup>th</sup> Floor  
Veterans Memorial Highway, Hauppauge**

**All project materials can be found at:**

<http://www.suffolkcountyny.gov/Departments/Planning/Boards/CouncilonEnvironmentalQuality>

### **Call to Order:**

### **Minutes:**

March 2013

### **Correspondence:**

### **Public Portion:**

### **Historic Trust Docket:**

Director's Report:

Updates on Housing Program for Historic Trust Sites

Updates on Historic Trust Custodial Agreements

**Project Review:**

**Recommended Unlisted Actions:**

- A. Proposed CP#5603 – Yaphank CNG Fueling Facility

**Recommended Type II Actions:**

- A. Ratification of Recommendations for Legislative Resolutions Laid on the Table March 19, 2013

**Other Business:**

Suffolk County Stormwater Management Program Annual Report 2013

**CAC Concerns:**

**\*CAC MEMBERS:** The above information has been forwarded to your local Legislators, Supervisors and DEC personnel. Please check with them prior to the meeting to see if they have any comments or concerns regarding these projects that they would like brought to the CEQ's attention.

**\*\*CEQ MEMBERS:** PLEASE NOTIFY THIS OFFICE AS SOON AS POSSIBLE IF YOU WILL BE UNABLE TO ATTEND.

**\*\*\*FOLLOWING THE MEETING PLEASE LEAVE BEHIND ALL PROJECT MATERIAL THAT YOU DO NOT WANT OR NEED AS WE CAN RECYCLE THESE MATERIALS LATER ON.**

# COUNTY OF SUFFOLK



STEVEN BELLONE  
COUNTY EXECUTIVE

DEPARTMENT OF ECONOMIC DEVELOPMENT AND PLANNING  
DIVISION OF PLANNING AND ENVIRONMENT

COUNCIL ON ENVIRONMENTAL QUALITY

GLORIA RUSSO  
CHAIRPERSON  
CEQ

## SUFFOLK COUNTY COUNCIL ON ENVIRONMENTAL QUALITY MINUTES

DATE: April 17, 2013

TIME: 9:30 am to 11:25 am

LOCATION: Arthur Kunz Library  
H. Lee Dennison Bldg. – 4<sup>th</sup> Floor  
Veterans Memorial Highway, Hauppauge, New York

### PRESENT:

Gloria Russo, Chair  
James Bagg, Vice-Chair  
Eva Growney  
Thomas Gulbransen  
Michael Kaufman  
Richard Machtay  
Dan Pichney  
Mary Ann Spencer  
Larry Swanson

### ABSENT:

Hon. Kara Hahn

### CAC REPRESENTATIVES:

None

### STAFF:

Peter Scully Jr., Assistant County Attorney  
Andrew Freleng, Chief Planner  
John Corral, Planner  
Christine DeSalvo, Senior Clerk Typist

### GUESTS:

Richard Martin, Director of Historic Services, Suffolk County Dept. of Parks, Recreation & Conservation  
Raymond Muxo, Associate Mechanical Engineer, Suffolk County Department of Public Works  
Greg Mead, Project Coordinator, Suffolk County Department of Public Works  
Jay Abbott, Projects Supervisor, Suffolk County Department of Public Works

John Perrotta, Project Manager, Nelson & Pope  
John Stalzer, Sr. Environmental Scientist, Nelson & Pope  
Chris Lubicich, Public Health Engineer, Suffolk County Department Health Services, Office of Ecology  
Michael Pitcher, Director of Communications, Suffolk County Legislature  
Erik Bergey, Suffolk County Department of Economic Development & Planning  
Mark Cappellino, Stormwater Educator, Cornell Cooperative Extension  
Scott Curatolo-Wagemann, Stormwater Specialist, Cornell Cooperative Extension  
Lorne Brousseau, GIS and Stormwater Program Manager, Cornell Cooperative Extension  
Emerson Hasbrouck, Stormwater Management, Cornell Marine Program  
Rick Brand, Newsday

**Minutes:**

Minutes for the March 20, 2013 CEQ meeting were reviewed and discussed. Ms. Growney, Mr. Machtay, and Mr. Pichney all noted that since they were unable to attend the March 20, 2013 meeting they would abstain from voting. A motion was made by Mr. Kaufman to approve the March 20, 2013 minutes. The motion was seconded by Mr. Bagg.  
Motion carried.

**Correspondence:**

None

**Historic Trust Docket:**

Director's Report:

Mr. Martin updated the Council on the following:

- **Housing Program:**  
Mr. Martin noted that there are now a total of three vacancies in the Housing Program. It was noted that two of these rental properties, the Isaac Mills House in St James and the West Sayville Montauk Highway Gate House, are recent vacancies. The third noted vacancy, the First House at the Robinson Duck Farm, has been vacant for a number of years but has now been renovated and is available to rent. A County employee wide mailing regarding these vacancies will be conducted followed by scheduled open houses.
- **Custodial Agreements:**  
Mr. Martin noted that there are no new updates. Contracts are still in progress and there have been no contracts finalized since the Council's last meeting.
- **Current Events:**  
Mr. Martin announced that there has been a very successful book launch for the book entitled "Long Island Look". The book launch was held at the Scully Estate last weekend. The book contains many pictures of houses on the south shore of Long Island including six County Historic Sites: Sagtikos Manor, Timber Point, West Sayville Golf Course, Brookside in West Sayville, Meadowcroft, and the Scully Estate. Many of the pictures in the book are from the Suffolk County Department of Parks Historic Services office.

Mr. Martin announced an Earth Day event called the Eco Carnival at the Scully Estate on April 20, 2013 between 11am – 6 pm. Seatuck Association and Suffolk County Parks are the sponsors of this event.

Ms. Spencer requested that CEQ passes a resolution to authorize that a letter be sent to the Department of Public Works (DPW) requesting DPW proceed with the Request for Proposal (RFP) to do a Master Plan for the Hubbard County Park. It was noted that there are two important historic sites at the Hubbard County Park which includes the Flanders Club and the Black Duck Lodge. In addition it was noted that the Master Plan would address the environmental sensitive areas in the Park.

Mr. Bagg asked if the money is already in place and Ms. Spencer and Mr. Martin noted that the money is in place because it is from a New York State grant. It was also clarified that the letter should go to DPW because DPW generates the RFP but that the Department of Parks will be reviewing the RFP.

Mr. Kaufman added that the letter should also go to the EPA committee.

Mr. Swanson asked who would be involved in doing the Master Plan. Mr. Martin noted that DPW generates the RFP but that Suffolk County Department of Parks will be involved in the whole process.

Mr. Martin added that this should be discussed further with Nick Gibbons with the Department of Parks because he will be supervising the process.

Ms. Spenser's Motion was seconded by Mr. Machtay. Motion carried.

### **Project Review:**

#### **Recommended Unlisted Actions:**

##### **A. Proposed CP#5603 – Yaphank CNG Fueling Facility**

The project manager Mr. Ray Muxo, Associate Mechanical Engineer, Suffolk County Department of Public Works described the project to the CEQ which involves the construction of a Compressed Natural Gas (CNG) fueling facility and parking areas located within the existing Suffolk County North Yaphank Complex. Mr. Muxo noted that Greg Mead from Department of Public Works is the co-Project Manager and Nelson and Pope is the consultant for the project.

CEQ members asked Mr. Muxo about the risk of fires/explosions of the CNG fueling facility. Mr. Muxo noted that this facility will be in compliance with all State and local fire codes and regulations that govern this type of CNG facility.

CEQ members also discussed the area to be cleared and that there is County Park land nearby which includes historic structures such as the "Doctors Cottage". As a result of this CEQ added that during clearing the Department of Public Works should work with the Department of Parks to observe and preserve any artifacts that may be encountered.

A Motion was made by Mr. Kaufman to recommend classification of the proposed project as an Unlisted Action with a Negative Declaration. The Motion included that all local fire codes and State regulations governing the CNG Fueling Facility will be adhered to and that the Suffolk County Department of Public Works will coordinate with Suffolk County Department of Parks during the clearing to observe and preserve any artifacts which may be encountered. Ms. Growney seconded the motion. Motion carried.

**Recommended Type II Actions:**

- A. Ratification of Recommendations for Legislative Resolutions Laid on the Table for March 19, 2013.

Mr. Kaufman made a motion to accept staff recommendations as presented for the March 19, 2013 Legislative Resolutions. The motion was seconded by Mr. Gulbransen. Motion carried.

**Other Business:**

Suffolk County Stormwater Management Program Annual Report 2013

A presentation was given by Mr. Hasbrouck on the Suffolk County Stormwater Management Program.

**Public Portion:**

No comments were presented at this time.

**CAC Concerns:**

None

Meeting Adjourned.

# COUNTY OF SUFFOLK



**STEVEN BELLONE**  
SUFFOLK COUNTY EXECUTIVE

DEPARTMENT OF PUBLIC WORKS

VINCENT FALKOWSKI, P.E.  
CHIEF DEPUTY COMMISSIONER

GILBERT ANDERSON, P.E.  
COMMISSIONER

PHILIP A. BERDOLT  
DEPUTY COMMISSIONER

April 5, 2013

Ms. Gloria Russo, Chairman  
Council on Environmental Quality  
Suffolk County Planning Department  
H. Lee Dennison Building – 4<sup>th</sup> floor  
100 Veterans Memorial Highway  
Hauppauge, New York 11788

**Re: CEQ Review for CP#5603 – Construction of New CNG Filling Station  
Yaphank Complex - 335 Yaphank Ave., Yaphank, NY**

Dear Ms. Russo:

Enclosed herewith please find 15 copies of the proposed preliminary aerial site plan, floor plans and Long Environmental Assessment Form for the above referenced project. The project involves the construction of a new Compressed Natural Gas fueling facility in the North Yaphank Complex in Yaphank along with other minor related ancillary work needed as the result of the establishment of said facility. Please review and forward the Council's SEQRA recommendation to the County Executive and Legislature.

Please contact me at 852-4225 should you need any additional information. Thank you.

Very truly yours,

for -  
Michael J. Monaghan, P.E.  
Chief Engineer, Facilities Engineering

MJM/RJM/ba

Enclosures

cc: Gilbert Anderson, P.E., Commissioner  
Vincent Falkowski, P.E., Chief Deputy Commissioner  
Philip Berdolt, Deputy Commissioner  
Andrew Freleng, Chief Planner, S.C. Planning Dept.  
John Corral, Planner, S.C. Planning Dept.  
James J. Ingenito, R.A., County Architect  
Raymond J. Muxo, P. E., Associate Mechanical Engineer  
Gregory Mead, Project Coordinator  
File: CP#5603

SUFFOLK COUNTY IS AN EQUAL OPPORTUNITY / AFFIRMATIVE ACTION EMPLOYER

H:\BDC\CEQ\2013 CEQ\CP#5603 - Yaphank CNG\CP5603 - Yaphank CNG - Memo to CEQ.doc



## SUFFOLK COUNTY FULL ENVIRONMENTAL ASSESSMENT FORM (EAF)

Instructions: This document is designed to assist in determining whether the action proposed may have a significant effect on the environment. Please complete the entire Data Sheet. Include as much information as possible such as feasibility studies, design reports, etc. Attach additional sheets if necessary. Mark irrelevant questions N.A., not applicable.

A. General Information:

1. Name of Project:

Construction of Compressed Natural Gas (CNG) Fueling Facilities

2. Location of Project: (specify Town, Village or Hamlet and include project location map on next page.)

Yaphank, Brookhaven, NY

Street Address:

Proximity of 335 Yaphank Avenue, Yaphank, NY 11980

Name of property or waterway:

North Yaphank Complex

3. Maps of Property and Project: Attach relevant available maps, including a location map (note: use road map, Hagstrom Atlas, U.S.G.S. topo map, tax map or equivalent) and preliminary site plans showing orientation, scale, buildings, roads, landmarks, drainage systems, areas to be altered by project, etc. See **Figure 2**.

4. Type of Project: (check one) New ; Expansion

5. Capital Program: Item #:5603 Date Adopted: TBD Amount: \$ 4.5 million

6. General Description of Project Including its Purpose (attach relevant design reports, plans, etc.):

Construction of Compressed Natural Gas (CNG) Fueling Facilities

7. Project Status: (check if begun)

	Start	Completion
PROPOSAL	<u>X</u>	<u>X</u>
STUDY	<u>X</u>	<u>X</u>
PRELIMINARY PLANNING	<u>X</u>	<u>X</u>
FINAL PLANS: SPECS	<u>X</u>	
SITE ACQUISITION	<u>NA</u>	<u>NA</u>
CONSTRUCTION	<u>Sept. 2013</u>	<u>Sept. 2014</u>
OTHER		

8. Departments Involved:

NAME AND ADDRESS OF DEPT. PERFORMING DESIGN & CONSTRUCTION	NAME AND ADDRESS OF INITIATING DEPT. (If different)
Name: SCDPW	
Street/P.O.: 335 Yaphank Avenue	
City, State: Yaphank, NY	
Zip: 11980	
Contact Person: Michael Monaghan, PE	
Business Phone: 631/852-4225	

B. Project Description

1. Scale of Project:

A	Total contiguous acres now owned at site:	2.80 acres*
B	Acreage to be acquired:	NA
C1	Developed acreage now:	1.55 acres
C2	Developed acreage at completion of project:	2.80 acres
C3	Developed acreage ultimately:	2.80 acres
D	Acreage of vegetation or cover to be removed:	1.32 acres
E	Acreage to remain undeveloped:	0.0
F1	Building gross floor area now:	NA
F2	Building gross floor area proposed:	NA
G1	Height of tallest structure on site now:	NA
G2	Height of tallest structure proposed on site:	Approx. 16 ft.
H	Proposed Building use (if any):	Filling Station Canopy
I1	Off-street parking spaces now:	±44 (w/in area to be disturbed)
I2	Off-street parking spaces proposed:	±54
J	Maximum vehicle trips/hr. when operational:	De minimis above existing conditions @ peak periods
K	Roads on site now:	0.49 acres
L	New road construction or reconstruction:	1.33 acres
M	Will project result in an increase in energy use? If yes, indicate type(s):	Electrical, natural gas
N	Will project require storage of liquid fuels and chemicals? If yes, describe substances and amounts to be stored:	No

\* Total contiguously adjacent area is 79.25 acres. Area of parcel in which project will take place is 64.22 acres. The area of the proposed action within the parcel totals 2.80 acres. The area provided in 1.B through 1.L is for the area of the proposed action, and not the parcel as a whole.

2. Project Schedule:

A	Is project single or multi-phase?	Single
B	If multi-phase, how many phases?	NA
C	Total construction time (months)	12

3. Wastes and Pollutants Generated During Project Construction and Operation:

		Components	Quantity	Mode of Disposal
A	Sanitary Sewage	NA		
B	Liquid industrial waste	NA		
C	Toxic chemicals	NA		
D	Pesticides or herbicides	NA		
E	Solid wastes	NA		
F	Clearing or demolition debris	Concrete/ Grubbing	TBD	
G	Spoil disposal or sedimentation	NA		
H	Atmospheric emissions	CNG	De minimis	
I	Surface water runoff	Stormwater	TBD	Leaching basins
J	Noise exceeding ambient	Compressors and shaving generator	*	
K	Odors exceeding 1hr/day	NA		
L	Other (specify)	NA		

\* Noise generated at the CNG dispensing facility will be intermittent and generated only when on-site equipment is in operation. There are no nearby sensitive receptors or residential uses which are likely to be significantly affected.

4. Does Project Involve Any:

Grading Cut/Fill (list amounts)	Grading will be completed – site expected to largely balance cut/fill
Dredging (list max. depth, length & width)	NA
Spoil Area (list amounts)	NA
Bulkheading (list length)	NA
Dewatering (list gpm & period of time)	NA

5. Indicate Sources of Utilities:

Water	NA
Electricity	New feeder from Board of Elections transformer
Gas	New service from Yaphank Avenue.
Other (please specify)	Data lines, internal to the Suffolk County complex.

6. Total Water Usage:

Gallons per Day:	NA
If water supply is from wells, indicate pumping capacity in gallons per minute:	

C. Project Area Description/Existing Conditions:

1. Acreage of Physical Characteristics of Project Area:

	Presently	After Completion
Meadow, field, scrub growth	0	0
Wooded	1.25	0
Agricultural	0	0
Freshwater wetland	0	0
Tidal wetlands	0	0
Surface waters	0	0
Cleared, graded or filled land	0	0
Paved areas (roads, parking, etc.)	0.49	1.81
Buildings (List number and sq. ft.)	0	1 – Dispenser Island Canopy (5,120 SF)
Other (please specify) Turf Grass	1.06	0.99
TOTAL	2.80	2.80

2. Streams within or contiguous to project area: *(Please list name of stream and/or name of river to which it is tributary, including intermittent streams)*

None

3. Lakes, Ponds, Wetland areas within or contiguous to project area: *(Please list name(s) and size(s) in acres)*

None

4. a. Are there natural drainage channels on the project site? Yes  No

b. How far is project area from freshwater wetlands, tidal wetlands or surface waters?

Approximately 1,500 feet from west bank of freshwater wetlands associated with the Carmans River

5. Is the Project area within the 100 yr. Flood plain? Yes  No

6. Depth to the water table: at surface ; 0-3 ft. ; 3-8 ft. ; 8-16 ft. ; 16 ft.  (approx. 50 ft)

7. Predominant soil type (s) on project site as identified in the Soil Survey of Suffolk County (1975): *(Include soils map of site.)*

RdA, HaA & RdB (See **Figure 1**)

8. General character of the land:

Generally uniform slope ; Generally uneven and rolling or irregular

(Include topographic map of site.) See **Figure 2**.

9. Approximate percentage of proposed project site with slopes:

0-10% 100; 10-15% \_\_\_\_\_; >15% \_\_\_\_\_

10. Any unique or unusual land forms on the project site?

(i.e. cliffs, dunes, kettle holes, eskers, other geological formations):

None

11. Describe the predominant vegetation types on the site:

Landscaping, turf grass, pine oak (edge habitat).

12. Describe the predominant wildlife on the site:

Due to the lesser quality edge habitat, and developed nature of the site wildlife is limited to suburban communities of squirrel, variety of birds, and the potential for fox and/or deer.

13. Does project site contain any species of plant or animal life that is identified as threatened or endangered? Yes ; No

If Yes, give source and identify each species:

14. Is project contiguous to, or does it contain a building or site of historic, pre-historic or paleontological importance? Yes ; No

If Yes, explain:

15. List the specific activities now occurring at project location (i.e. hunting, fishing, hiking etc.)

County Office Complex and DPW yard

16. Is the project site presently used by the community or neighborhood as an open space or recreation area? Yes ; No

17. Does the present site offer or include scenic views or vistas known to be important to the community? Yes ; No

18. Zoning:

A	Current specific zoning or use classification of site?	A1 Residence district
B	Is proposed use consistent with present zoning or use?	Consistent with existing DPW facility use
C	If no, indicate desired zoning or use.	NA

19. What are the dominant land use and zoning classifications within a 1/4 mile radius of the project (e.g. single family residential, R-2) and the scale of development (e.g. 2 stories)?

(Include existing land use map)

Zoning: A1 Residence & L1 Industrial  
Land Use: Suffolk County Offices, single family residential, parkland.

20. Is the site served by existing public utilities? Yes; No  
 a) If yes, does sufficient capacity exist to allow connection? Yes; No  
 b) If yes, will improvements be necessary to allow connection? Yes; No
21. Is the site located in an agricultural district certified pursuant to Agriculture and Market Law, article 25-AA, Section 303 and 304? Yes; No
22. Is the site located in or substantially contiguous to a Critical Environmental Area designated pursuant to Article 8 of the ECL, and 6 NYCRR 617? Yes; No
23. Has the site ever been used for disposal of solid or hazardous wastes? Yes; No

D. Impact Summary and Mitigation

1. How many acres of vegetation (trees, shrubs, ground cover, etc.) will be removed from site?

1.32 acres including pitch pine oak and turf grass (landscaping)

2. Will any mature forest or other locally important vegetation be removed by this project?

Yes; No

If Yes, explain:

3. Are there plans for erosion control and stabilization? Yes; No

If Yes, explain and attach plans:

A SWPPP will be developed as will soil and erosion control plans.

4. Are there any plans for revegetation to replace that removed during construction? Yes; No

If Yes, explain and attach plans:

Area of disturbance will be replanted with turf grass for landscaping and erosion control.

5. Will project physically alter any surface water bodies? Yes; No

If Yes, explain:

6. Will project require relocation of any projects, facilities or homes? Yes; No

If Yes, explain:

7. Number of jobs generated:

During construction?	±30
After project is completed?	0

8. Number of jobs eliminated by this project:

0

E. Alternatives

Briefly list alternatives to the proposal considered:

No-build alternative and Lesser-build alternative in which the CNG facility will be constructed, but parking lot improvements to the south of the main building will not.

F. Approval and Compliance

1. Will project involve funding or financing by any:

	Agency Name	\$ Amount
Federal Agency	Federal Highway Admin.	80% matching (\$3.6 million)
State Agency		
Local Agency	Suffolk County	20% match (\$900,000)

2. Does project require permit or approval from the following agencies:

	Yes	No	Type
Army Corps of Engineers	<input type="checkbox"/>	<input checked="" type="checkbox"/>	
U.S. Environmental Protection	<input type="checkbox"/>	<input checked="" type="checkbox"/>	
Other Federal agency (specify)	<input checked="" type="checkbox"/>	<input type="checkbox"/>	Federal Highway Admin.
N.Y.S. Environmental Conservation Department	<input checked="" type="checkbox"/>	<input type="checkbox"/>	GP-0-10-001 (stormwater)
Other State agency (specify)	<input checked="" type="checkbox"/>	<input type="checkbox"/>	NYSDOT for funding approval
County Health Department	<input type="checkbox"/>	<input checked="" type="checkbox"/>	
County Planning Department	<input type="checkbox"/>	<input checked="" type="checkbox"/>	
County Public Works Department	<input checked="" type="checkbox"/>	<input type="checkbox"/>	Review of project plans
Town or Village Board	<input type="checkbox"/>	<input checked="" type="checkbox"/>	
Town or Village Planning Board	<input type="checkbox"/>	<input checked="" type="checkbox"/>	
Town or Village Zoning Board	<input type="checkbox"/>	<input checked="" type="checkbox"/>	
Town or Village Building Department	<input type="checkbox"/>	<input checked="" type="checkbox"/>	
Town or Village Highway Department	<input type="checkbox"/>	<input checked="" type="checkbox"/>	
Town or Village Environmental Agency	<input type="checkbox"/>	<input checked="" type="checkbox"/>	
Local Fire Marshal	<input checked="" type="checkbox"/>	<input type="checkbox"/>	Site Plan approval of fire suppression systems, via DPW
Other local agency (specify i.e. CAC)	<input type="checkbox"/>	<input checked="" type="checkbox"/>	

3. Is project in conformance with existing comprehensive or project master plans?

	Yes	No	Description
State	<input type="checkbox"/>	<input type="checkbox"/>	NA
Bi-County	<input type="checkbox"/>	<input type="checkbox"/>	NA
County	<input checked="" type="checkbox"/>	<input type="checkbox"/>	Site is within a County office complex.
Town	<input checked="" type="checkbox"/>	<input type="checkbox"/>	Area designated for public and semi-public use.
Village	<input type="checkbox"/>	<input type="checkbox"/>	NA

PREPARER John Stalzer, Nelson, Pope & Voorhis, LLC Date April 5, 2013

TITLE Sr. Environmental Scientist

SIGNATURE\*

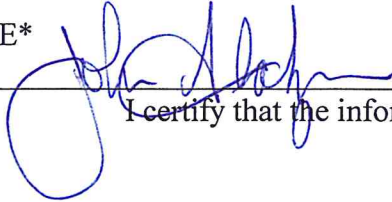

\_\_\_\_\_  
I certify that the information herein is accurate.

PROJECT DIRECTOR \_\_\_\_\_ Date April 5, 2013

TITLE

SIGNATURE\*

\_\_\_\_\_  
I certify that the information herein is accurate

\*Signature of both preparer and project director required



## Part 2 - RESPONSIBILITY OF LEAD AGENCY

### Project Impacts and Their Magnitude

#### General Information (Read Carefully)

1. In completing the form the reviewer should be guided by the question: Have my decisions and determinations been **reasonable?** The reviewer is not expected to be an expert environmental analyst.
2. Identifying that an effect will be potentially large (column 2) does not mean that it is also necessarily **significant**. Any large impact must be evaluated in PART 3 to determine significance. By identifying an impact in column 2 simply asks that it be looked at further.
3. The **Examples** provided are to assist the reviewer by showing types of impacts and wherever possible the threshold of magnitude that would trigger a response in column 2. The examples are generally applicable throughout the State and for most situations. But, for any specific project or site other examples and/or lower thresholds may be appropriate for a Potential Large Impact rating.
4. Each project, on each site, in each locality, will vary. Therefore, the examples have been offered as guidance. They do not constitute an exhaustive list of impacts and thresholds to answer each question.
5. The number of examples per question does not indicate the importance of each question.

#### Instructions (Read carefully)

1. Answer each of the 19 questions in PART 2. Answer **Yes** if there will be **any** impact.
2. **Maybe** answers should be considered as **Yes** answers.
3. If answering **Yes** to a question then check the appropriate box (column 1 or 2) to indicate the potential size of the impact. If threshold impact equals or exceeds any example provided, check column 2. If impact will occur but threshold is lower than example, check column 1.
4. If reviewer has doubt about size of the impact then consider the impact as potentially large and proceed to PART 3.
5. If a potentially large impact or effect can be mitigated by a change in the project to a less than large magnitude, check the yes box in column 3. A No response indicates that such a reduction is not possible.

#### IMPACT ON LAND

1. Will the proposed action result in a physical change to the project site?  Yes  No

<b>IMPACT ON LAND</b> Examples that would apply to Column 1	<b>1</b> Small to Moderate Impact	<b>2</b> Potential Large Impact	<b>3</b> Can Impact Be Mitigated By Project Change (Enter Yes or No)
Any construction on slopes of 15% or greater, (15 foot rise per 100 foot of length), or where the general slopes in the project area exceed 10%.			
Construction of land where the depth to the water table is less than 3 feet.			
Construction of paved parking area for 1,000 or more vehicles.			
Construction on land where bedrock is exposed or generally within 3 feet of existing ground surface.			
Construction that will continue for more than a year or involve more than one phase or stage.			
Excavation for mining purposes that would remove more than 1,000 tons of natural material (i.e., rock or soil) per year.			

<b>IMPACT ON LAND</b>	<b>1 Small to Moderate Impact</b>	<b>2 Potential Large Impact</b>	<b>3 Can Impact Be Mitigated By Project Change (Enter Yes or No)</b>
Construction of any new sanitary landfill.			
Construction in a designated floodway.			
Other Impacts (Please describe)			

2. Will there be an effect to any unique or unusual land forms found on the site? (i.e., cliffs, dunes, geological formations, etc.)  
 \_\_\_ yes X no.

List Specific land forms:			
---------------------------	--	--	--

**IMPACT ON WATER**

3. Will proposed action affect any water body designated as protected? (under Articles 15,24,25 of the Environmental Conservation Law, ECL) \_\_\_ yes X no.

<b>IMPACT ON WATER (Examples that would apply to column 2)</b>	<b>1 Small to Moderate Impact</b>	<b>2 Potential Large Impact</b>	<b>3 Can Impact Be Mitigated By Project Change (Enter Yes or No)</b>
Developable area of site contains a protected water body.			
Dredging more than 100 cubic yards of material from channel of a protected stream.			
Extension of utility distribution facilities through a protected water body.			
Construction in a designated freshwater or tidal wetland.			
Please List Other Impacts:			

4. Will proposed action affect any non-protected existing or new body of water? \_\_\_ yes X no

A 10% increase or decrease in the surface area of any body of water or more than a 10 acre increase or decrease.			
Construction of a body of water that exceeds 10 acres of surface area.			
Please List Other Impacts:			

5. Will proposed action affect surface or groundwater quality? \_\_\_ yes X no

Proposed Action will require a discharge permit.			
Proposed Action requires use of a source of water that does not have approval to serve proposed (project) action.			
Proposed Action requires water supply from wells with greater than 45 gallons per minute pumping capacity.			

<p align="center"><b>IMPACT ON WATER (cont.)</b> (Examples that would apply to column 2)</p>	<p align="center"><b>1</b> Small to Moderate Impact</p>	<p align="center"><b>2</b> Potential Large Impact</p>	<p align="center"><b>3</b> Can Impact Be Mitigated By Project Change (Enter Yes or No)</p>
Construction or operation causing any contamination of a public water supply system.			
Proposed Action will adversely affect groundwater.			
Liquid effluent will be conveyed off the site to facilities which presently do not exist or have inadequate capacity.			
Proposed Action requiring a facility that would use water in excess of 20,000 gallons per day.			
Proposed Action will likely cause siltation or other discharge into an existing body of water to the extent that there will be an obvious visual contrast to natural conditions.			
Proposed Action will require the storage of petroleum products greater than 1,100 gallons.			
Proposed Action will allow residential uses in areas without water and/or sewer services.			
Proposed Action locates commercial and/or industrial uses which may require new or expansion of existing waste treatment and/or storage facilities.			
Please list other impacts:			

6. Will proposed action alter drainage flow, patterns or surface water runoff? X yes \_\_\_ no.

Proposed Action would impede flood water flows.			
Proposed Action is likely to cause substantial erosion.			
Proposed Action is incompatible with existing drain patterns.			
Proposed Action will allow development in a designated floodway.			
Please list other impacts: The proposed action will direct stormwater flow to leaching basins.	X		

**IMPACT ON AIR**

7. Will proposed action affect air quality? \_\_\_ yes X no.

<p align="center"><b>IMPACT ON AIR</b> (Examples that would apply to column 2)</p>	<p align="center"><b>1</b> Small to Moderate Impact</p>	<p align="center"><b>2</b> Potential Large Impact</p>	<p align="center"><b>3</b> Can Impact Be Mitigated By Project Change (Enter Yes or No)</p>
Proposed Action will induce 1,000 or more vehicle trips in given hour.			
Proposed Action will result in the incineration of more than 1 ton of refuse per hour.			

IMPACT ON AIR (cont.)	1 Small to Moderate Impact	2 Potential Large Impact	3 Can Impact Be Mitigated By Project Change (Enter Yes or No)
Proposed Action emission rate of all contaminants will exceed 5 lbs. per hour or a heat source producing more than 10 million BTU's per hour.			
Proposed Action will allow an increase in the amount of land committed to industrial use.			
Proposed Action will allow an increase in the density of industrial development in existing industrial areas.			
Please List Other Impacts: The proposed action would replace gasoline powered vehicles with CNG vehicles thereby reducing greenhouse gas emissions and other air pollutants.			

**IMPACT ON PLANTS AND ANIMALS**

8. Will Proposed Action affect any threatened or endangered species? \_\_\_ yes X no.

IMPACT ON PLANTS AND ANIMALS (Examples that would apply to Column 2)	1 Small to Moderate Impact	2 Potential Large Impact	3 Can Impact Be Mitigated By Project Change (Enter Yes or No)
Reduction of one or more species listed on the New York or Federal list, using the site, over or near site or found on the site.			
Removal of any portion of a critical or significant wildlife habitat.			
Application of pesticide or herbicide over more than twice a year other than for agricultural purposes.			
Please list other impacts:			

9. Will Proposed Action substantially affect non-threatened or endangered species? \_\_\_ Yes X No

Proposed Action would substantially interfere with any resident or migratory fish or wildlife species.			
Proposed Action requires the removal of more than 10 acres of mature forest (over 100 years of age) or other locally important vegetation.			

**IMPACT ON AGRICULTURAL LAND RESOURCES**

10. Will the Proposed Action affect agricultural land resources? \_\_\_ Yes X No

IMPACT ON AGRICULTURAL LAND RESOURCES (Examples that would apply to Column 2)	1 Small to Moderate Impact	2 Potential Large Impact	3 Can Impact Be Mitigated By Project Change (Enter Yes or No)
The Proposed Action would sever, cross through, or limit access to a field of agricultural land (includes cropland, hayfields, pasture, vineyard, orchard, etc.			

IMPACT ON AGRICULTURAL LAND RESOURCES (cont.)	1 Small to Moderate Impact	2 Potential Large Impact	3 Can Impact Be Mitigated By Project Change (Enter Yes or No)
Construction activity would excavate or compact the soil profile of agricultural land.			
The Proposed Action would irreversibly convert more than 10 acres of agricultural land or, if located in an Agricultural District, more than one acre of agricultural land.			
The Proposed Action would disrupt agricultural land management systems (e.g., subsurface drain lines, outlet ditches, strip cropping); prevent agricultural land management measures from being installed; or create a need for such measures (e.g., cause a farm field to drain poorly due to increased runoff)			
Prime or unique farmland as defined by USDA-SCS 7 CFR Part 657 and governed by the Farmland Protection Policy Act of 1981 is involved.			
Please list other impacts:			

**IMPACT ON AESTHETIC RESOURCES OR COMMUNITY CHARACTER**

11. Will proposed action affect aesthetic resources, or the character of the neighborhood or community? Yes  No

IMPACT ON AESTHETIC RESOURCES OR COMMUNITY CHARACTER (Examples that would apply to column 2) (If Necessary Use the Visual EAF Addendum in Section 617.23)	1 Small to Moderate Impact	2 Potential Large Impact	3 Can Impact Be Mitigated By Project Change (Enter Yes or No)
Introduction of proposed land uses, projects or project components obviously different or in sharp contrast to current surrounding land use patterns or existing man-made additions to the landscape.			
Introduction of proposed land uses, projects or project components as described in the above example that will be visible to users of aesthetic resources. This will eliminate or significantly reduce the public enjoyment or appreciation of the appearance or aesthetic qualities of a resource or community character.			
Introduction of project components that will result in the elimination or significant screening of scenic views known to be important to the area.			
Please list other impacts:			

**IMPACT ON HISTORIC AND ARCHEOLOGICAL RESOURCES**

12. Will Proposed Action impact any site or structure of historic, prehistoric or paleontological importance?  Yes  No

<b>IMPACT ON HISTORIC AND ARCHEOLOGICAL RESOURCES</b> (Examples that would apply to column 2)	<b>1</b> <b>Small to Moderate Impact</b>	<b>2</b> <b>Potential Large Impact</b>	<b>3</b> <b>Can Impact Be Mitigated By Project Change</b> <b>(Enter Yes or No)</b>
Proposed Action occurring wholly or partially within or contiguous to any facility or site listed or eligible for listing on the State or National Register of historic places.			
Any impact to an archeological site or fossil bed located within the project site.			
Proposed Action will occur in an area designated as sensitive for archeological sites on the NSY Site Inventory.	X		
Please list other impacts: Construction is within areas of previously disturbed land (per current conditions and review of historic aerials).			

A letter will be sent to the State Historic Preservation Office (SHPO) to identify the project. All actions required by SHPO will be followed prior construction of the proposed action.

**IMPACT ON OPEN SPACE AND RECREATION**

13. Will Proposed Action affect the quantity or quality of existing or future open spaces or recreational opportunities?  Yes  No

<b>IMPACT ON OPEN SPACE AND RECREATION</b> (Examples that would apply to column 2)	<b>1</b> <b>Small to Moderate Impact</b>	<b>2</b> <b>Potential Large Impact</b>	<b>3</b> <b>Can Impact Be Mitigated By Project Change</b> <b>(Enter Yes or No)</b>
The permanent foreclosure of a future recreational opportunity.			
A major reduction of an open space important to the community.			
Please list other impacts:			

**IMPACT ON CRITICAL ENVIRONMENTAL AREAS**

14. Will Proposed Action impact the exceptional or unique characteristics of a critical environmental area (CEA) established pursuant to subdivision 6 NYCRR 617.14(g)?  Yes  No

List the environmental characteristics that caused the designation of the CEA.

---



---



---



---

<b>IMPACT ON CRITICAL ENVIRONMENTAL AREAS</b> (Examples that would apply to column 2)	<b>1</b> Small to Moderate Impact	<b>2</b> Potential Large Impact	<b>3</b> Can Impact Be Mitigated By Project Change (Enter Yes or No)
Proposed Action to locate within the CEA?			
Proposed Action will result in a reduction in the quantity of the resource?			
Proposed Action will result in a reduction in the quality of the resource?			
Proposed Action will impact the use, function or enjoyment of the resource?			
Please list other impacts.			

**IMPACT ON TRANSPORTATION**

15. Will there be an effect to existing transportation systems? \_\_\_ Yes X No

<b>IMPACT ON TRANSPORTATION</b> (Examples that would apply to column 2)	<b>1</b> Small to Moderate Impact	<b>2</b> Potential Large Impact	<b>3</b> Can Impact Be Mitigated By Project Change (Enter Yes or No)
Alteration of present patterns of movement of people and/or goods.			
Proposed Action will result in severe traffic problems			
Please list other impacts:			

**IMPACT ON ENERGY**

16. Will proposed action affect the communities sources of fuel or energy supply? \_\_\_ Yes X No

<b>IMPACT ON ENERGY</b> (Examples that would apply to column 2)	<b>1</b> Small to Moderate Impact	<b>2</b> Potential Large Impact	<b>3</b> Can Impact Be Mitigated By Project Change (Enter Yes or No)
Proposed Action will cause a greater than 5% increase in any form of energy in municipality.			
Proposed Action will require the creation or extension of an energy transmission or supply system to serve more than 50 single or two family residences.			
Please list other impacts: Existing natural gas supply will not be significantly changed.			

**IMPACT ON NOISE**

17. Will there be objectionable odors, noise, glare, vibration or electrical disturbance as a result of the Proposed Action?

Yes  No

<p align="center"><b>IMPACT ON NOISE</b> (Examples that would apply to column 2)</p>	<p align="center"><b>1</b> Small to Moderate Impact</p>	<p align="center"><b>2</b> Potential Large Impact</p>	<p align="center"><b>3</b> Can Impact Be Mitigated By Project Change (Enter Yes or No)</p>
Blasting within 1,500 feet of a hospital, school or other sensitive facility.			
Odors will occur routinely (more than one hour per day).			
Proposed Action will produce operating noise exceeding the local ambient noise levels for noise outside of structures.			
Proposed Action will remove natural barriers that would act as a noise screen.			
Please list other impacts: The on-site noise generated by compressors and generators will be intermittent. The proposed CNG facility is located within a Suffolk County complex. There are no sensitive receptors or residential uses nearby.			

**IMPACT ON PUBLIC HEALTH AND (HAZARDS) SAFETY**

18. Will Proposed Action affect public health and safety?  Yes  No

<p align="center"><b>IMPACT ON PUBLIC HEALTH AND (HAZARDS) SAFETY</b> (Examples that would apply to column 2)</p>	<p align="center"><b>1</b> Small to Moderate Impact</p>	<p align="center"><b>2</b> Potential Large Impact</p>	<p align="center"><b>3</b> Can Impact Be Mitigated By Project Change (Enter Yes or No)</p>
Proposed Action will cause a risk of explosion or release of hazardous substances (i.e. oil, pesticides, chemicals, radiation, etc.) in the event of accident or upset conditions, or there will be a chronic low level discharge or emission.	X		
Proposed Action will result in the burial of "hazardous wastes" (i.e. toxic, poisonous, highly reactive, radioactive, irritating, infectious, etc., including wastes that are solid, semi-solid, liquid or contain gases).			
Storage facilities for one million or more gallons of liquified natural gas or other liquids.			
Please list other impacts: Proposed action involves compressing natural gas for use in vehicles. According to the EPA, it has a narrow flammability range, making it an inherently safe fuel. In the event of a spill or accidental release, CNG poses no threat to land or water, as it is nontoxic.			



**IMPACT ON GROWTH AND CHARACTER OF COMMUNITY OR NEIGHBORHOOD**

19. Will Proposed Action affect the character of the existing Community?  Yes  No

<b>IMPACT ON GROWTH AND CHARACTER OF COMMUNITY OR NEIGHBORHOOD</b> (Examples that would apply to column 2)	<b>1</b> Small to Moderate Impact	<b>2</b> Potential Large Impact	<b>3</b> Can Impact Be Mitigated By Project Change (Enter Yes or No)
The population of the city, town or village in which the project is likely to grow by more than 5% of resident human population.			
The municipal budgets for capital expenditures or operating services will increase by more than 5% per year as a result of this project.			
Will involve any permanent facility of a non-agricultural use on more than one acre in an agricultural district or remove more than 10 acres of (prime) agricultural lands from cultivation.			
Proposed Action will replace or eliminate existing facilities, structures or areas of historic importance to the community.			
Development will in induce an influx of a particular age group with special needs.			
Proposed Action will set an important precedent for future projects.			
Proposed Action will relocate 15 or more employees in one or more businesses.			
Please List other impacts:			

**PUBLIC INPUT**

20. Is there public controversy related to Potential Adverse Environmental Impacts?  Yes  No

Either government or citizens of adjacent communities have expressed opposition or rejected the project or have not been contacted.			
Objections to the project from within the community.			

**If Any Action in Part 2 Is Identified as a Potential Large Impact  
or If You Cannot Determine the Magnitude of Impact, Proceed to Part 3**

Determination of Significance

Portions of EAF completed for this project:       X   Part 1     X   Part 2      Part 3

Upon review of the information recorded on this EAF (Parts 1, 2 and 3) and considering both the magnitude and importance of each impact, it is reasonably determined that:

- A.     The project will result in no major impacts and, therefore, is one which may not cause significant damage to the environment.     **Prepare a negative declaration:**
- B.     **For unlisted actions only.** Although the project could have a significant effect on the environment, there will not be a significant effect in this case because the mitigation measures described in Part # have been included as part of the proposed project.     **Prepare a CONDITIONAL negative declaration:**
- C.     The project will result in one or more major adverse impacts that cannot be reduced and may cause significant damage to the environment.     **Prepare a positive declaration , proceed with EIS:**

\_\_\_\_\_  
Signature of Preparer (if different from responsible officer)

Date

\_\_\_\_\_  
Signature of Responsible Officer in Lead Agency

Print or Type Name of Responsible Officer in Lead Agency

\_\_\_\_\_  
Name of Lead Agency

Date

## Part 3 - Responsibility of Lead Agency

### Evaluation of the Importance of Impacts

#### Information

Part 3 is prepared if one or more impact or effect is considered to be potentially large.

The amount of writing necessary to answer Part 3 may be determined by answering the question: In **briefly** completing the instructions below, have I placed in this record sufficient information to indicate the reasonableness of my decisions?

#### Instructions

Complete the following for each impact or effect identified in Column 2 of Part 2:

1. Briefly describe the impact.
2. Describe (if applicable) how the impact might be mitigated or reduced to a less than large impact by project change.
3. Based on the information available, decide if it is reasonable to conclude that this impact is **important** to the municipality (city, town or village) in which the project is located.

To answer the question of importance, consider:

- The probability of the impact or effect occurring
- The duration of the impact or effect
- Its irreversibility, including permanently lost resources of value
- Whether the impact or effect can be controlled
- The regional consequence of the impact or effect
- Its potential divergence from local needs and goals
- Whether known objectives to the project apply to this impact or effect

#### Determination of Significance

An action is considered to be significant if:

One (or more) impact(s) is determined to be (both) **large** and its (their) consequence, based on the review above, is **important**.

#### Part 3 Statements

(Continue on Attachments, as needed)

No impacts identified as potentially large.



**FIGURE 1  
SOIL MAP**

Source: Suffolk County Soil Survey  
Scale: 1 inch = 500 feet



**Suffolk County DPW  
CNG**



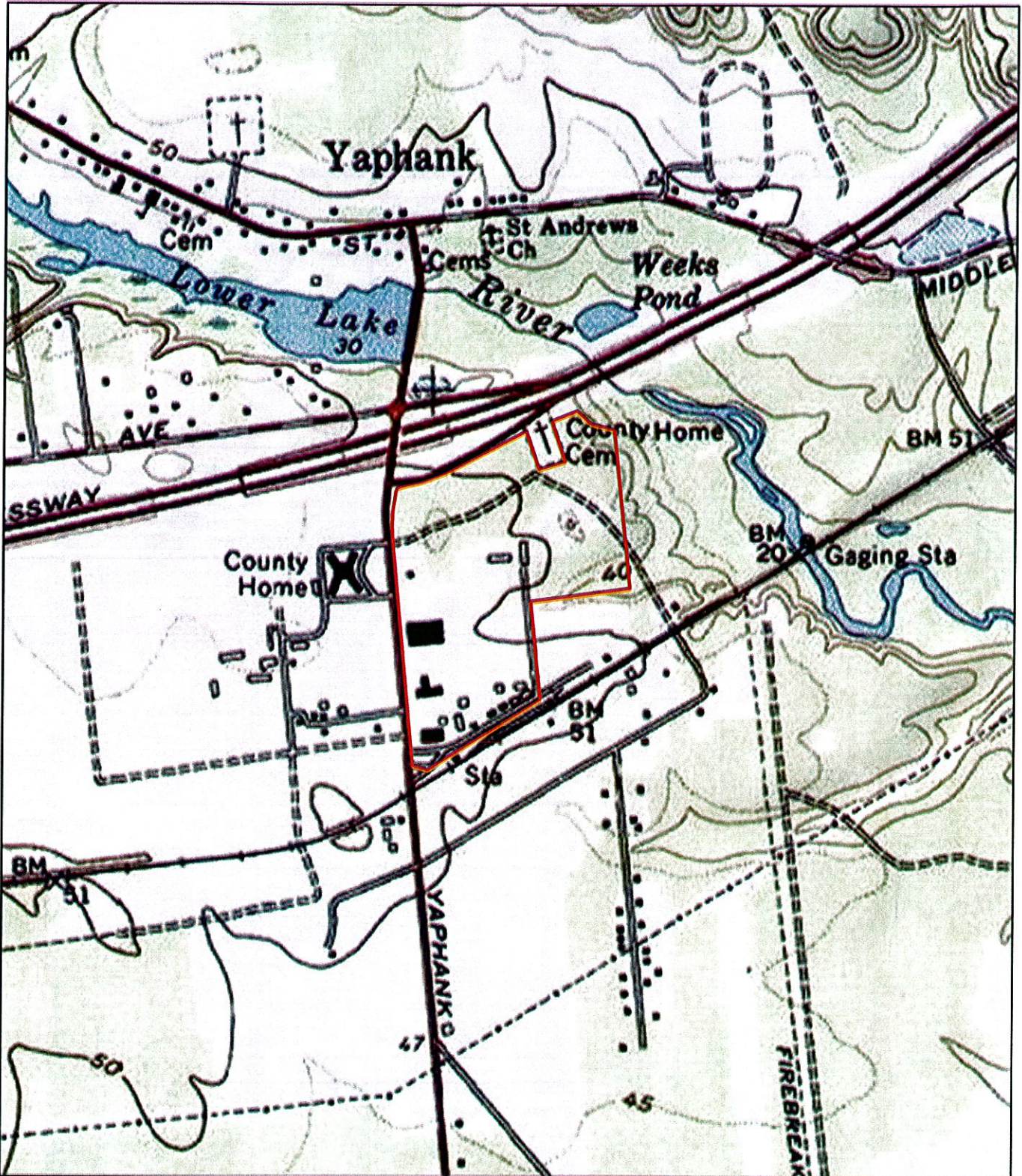

**FIGURE 2  
TOPOGRAPHIC MAP**

Source: ESRI Web Mapping Service, USGS  
 Scale: 1 inch = 1,000 feet



Suffolk County DPW  
 CNG





**PROJECT TITLE:** CONSTRUCTION OF COMPRESSED NATURAL GAS FACILITIES - YAPHANK, NEW YORK  
**SHEET TITLE:** AERIAL PLAN  
**DRAWN BY:** RH    **CHECK'D BY:** RJM    **SCALE:** NONE    **DATE:** 04.17.13

**REVISIONS:**

COUNTY OF SUFFOLK  
**DEPARTMENT OF PUBLIC WORKS**  
 YAPHANK, NEW YORK  
 GILBERT ANDERSON, P.E. COMMISSIONER    JAMES J. INGENITO, R.A. COUNTY ARCHITECT

**DWG. No:**  
**A-1**  
**DP No:** 5603    **BLDG. No:** XXXX



<b>PROJECT TITLE:</b>	<b>CONSTRUCTION OF COMPRESSED NATURAL GAS FACILITIES - YAPHANK, NEW YORK</b>		
<b>SHEET TITLE:</b>	<b>OVERALL AERIAL PLAN</b>		
<b>DRAWN BY:</b>	<b>RH</b>	<b>CHECK'D BY:</b>	<b>RJM</b>
<b>SCALE:</b>	<b>NONE</b>	<b>DATE:</b>	<b>04.17.13</b>

**REVISIONS:**

**COUNTY OF SUFFOLK**  
**DEPARTMENT OF PUBLIC WORKS**  
**YAPHANK, NEW YORK**  
**GILBERT ANDERSON, P.E.**  
**COMMISSIONER**

**DWG. No:**  
**A-2**  
**DP No:** 5603    **BLDG. No:** XXXX

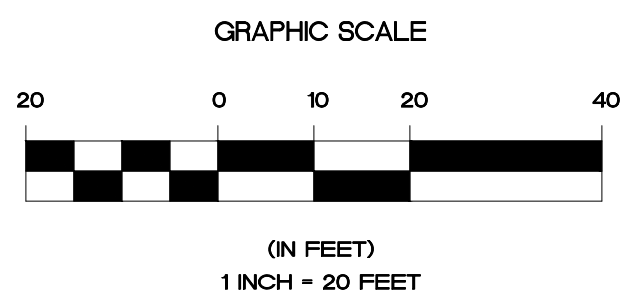
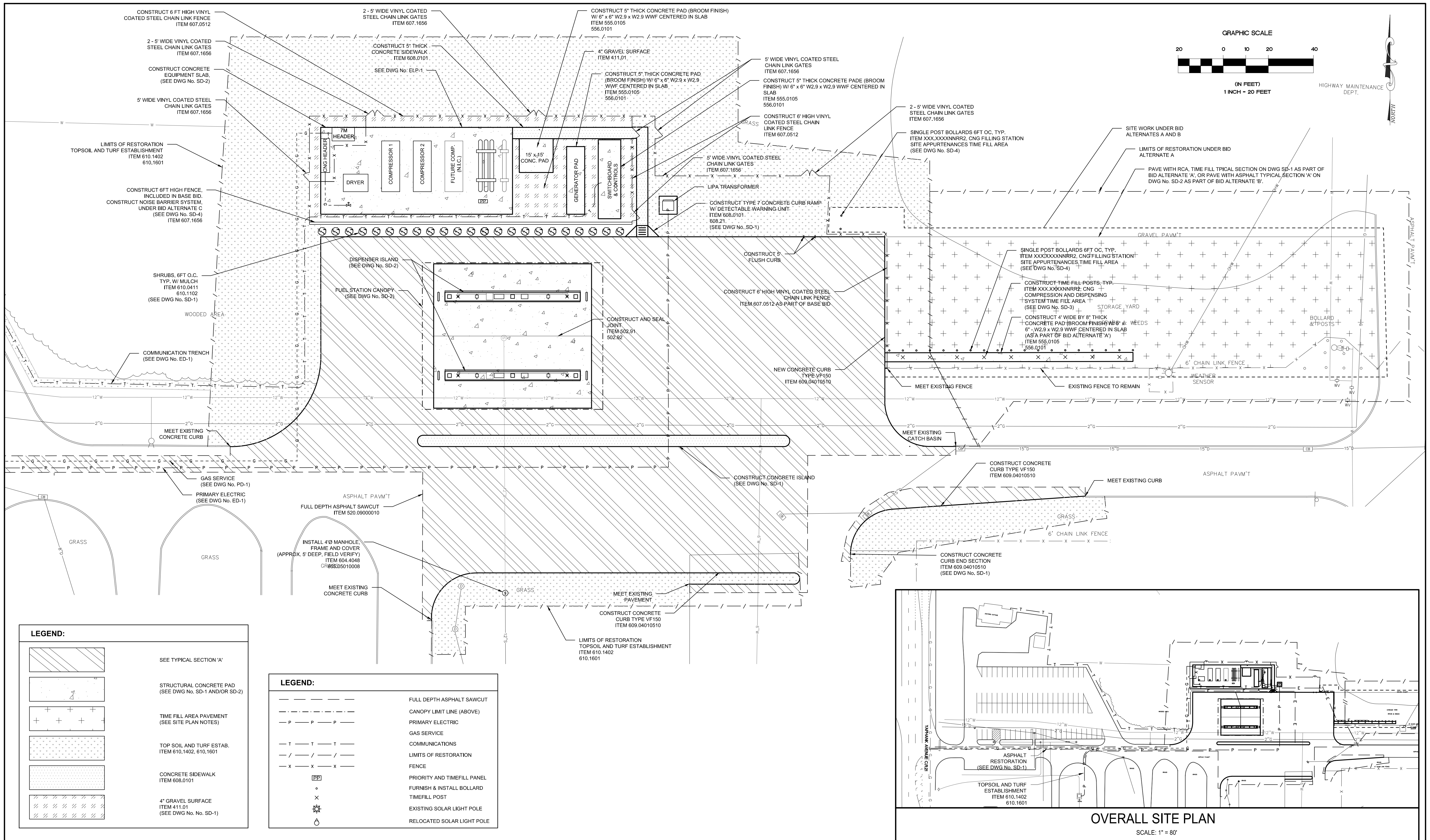

HIGHWAY MAINTENANCE DEPT.

**LEGEND:**

	SEE TYPICAL SECTION 'A'
	STRUCTURAL CONCRETE PAD (SEE DWG No. SD-1 AND/OR SD-2)
	TIME FILL AREA PAVEMENT (SEE SITE PLAN NOTES)
	TOP SOIL AND TURF ESTAB. ITEM 610.1402, 610.1601
	CONCRETE SIDEWALK ITEM 608.0101
	4" GRAVEL SURFACE ITEM 411.01 (SEE DWG No. No. SD-1)

**LEGEND:**

	FULL DEPTH ASPHALT SAWCUT
	CANOPY LIMIT LINE (ABOVE)
	PRIMARY ELECTRIC
	GAS SERVICE
	COMMUNICATIONS
	LIMITS OF RESTORATION
	FENCE
	PRIORITY AND TIMEFILL PANEL
	FURNISH & INSTALL BOLLARD
	TIMEFILL POST
	EXISTING SOLAR LIGHT POLE
	RELOCATED SOLAR LIGHT POLE

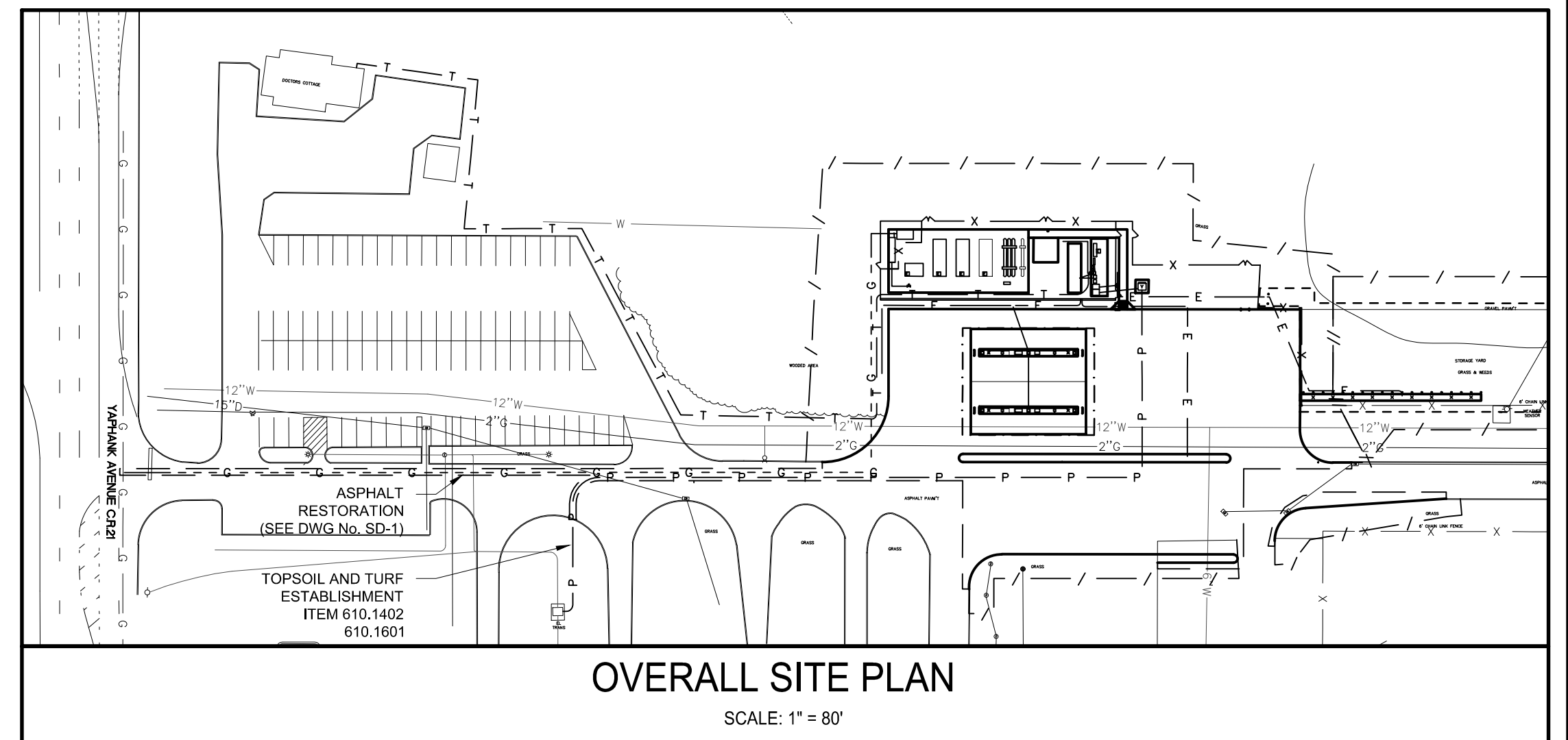

No.	DATE	REVISION	BY:
1	2/1/2013	90% SET ISSUED FOR SCDP/WNYSDOT REVIEW	JDN/HP

THIS DOCUMENT IS THE SOLE PROPERTY OF N&P ENGINEERS & SURVEYORS, PLLC, AND HAS BEEN PREPARED AND DISSEMINATED FOR THE SOLE USE OF OUR CLIENT. THIS DOCUMENT AND ANY DATA, CALCULATIONS, ESTIMATES OR DECISIONS CONTAINED HEREIN, MAY NOT BE UTILIZED BY ANY THIRD PARTY WITHOUT PRIOR WRITTEN CONSENT OF N&P ENGINEERS & SURVEYORS, PLLC, WHICH ASSUMES NO RISK OF LOSS OR LIABILITY RESULTING FROM ANY UNAUTHORIZED USE OR RELIANCE BY ANY THIRD PARTY.

CONSULTANT:

**NELSON & POPE**  
ENGINEERS • SURVEYORS  
572 WALT WHITMAN ROAD, MELVILLE, N.Y. 11747-2188  
(631) 427-5665 FAX (631) 427-5620  
WWW.NELSONPOPE.COM

CLIENT:

**SUFFOLK COUNTY DEPARTMENT OF PUBLIC WORKS**  
335 YAPHANK AVENUE  
YAPHANK, NEW YORK 11980

DWN. BY:	JD	DRAWING TITLE:	SITE PLAN - 1	DRAWING NUMBER:	SP-1
CHKD BY:	JRP	DATE:	FEBRUARY 2013		
JOB No.:	12120	CADD:	12120SITE		
SCALE:	AS SHOWN				

NEW COMPRESSED NATURAL GAS FILLING STATION  
SUFFOLK COUNTY - YAPHANK COMPLEX  
CP 5603.110 PIN 0759.61

SHEET: 7 OF 26



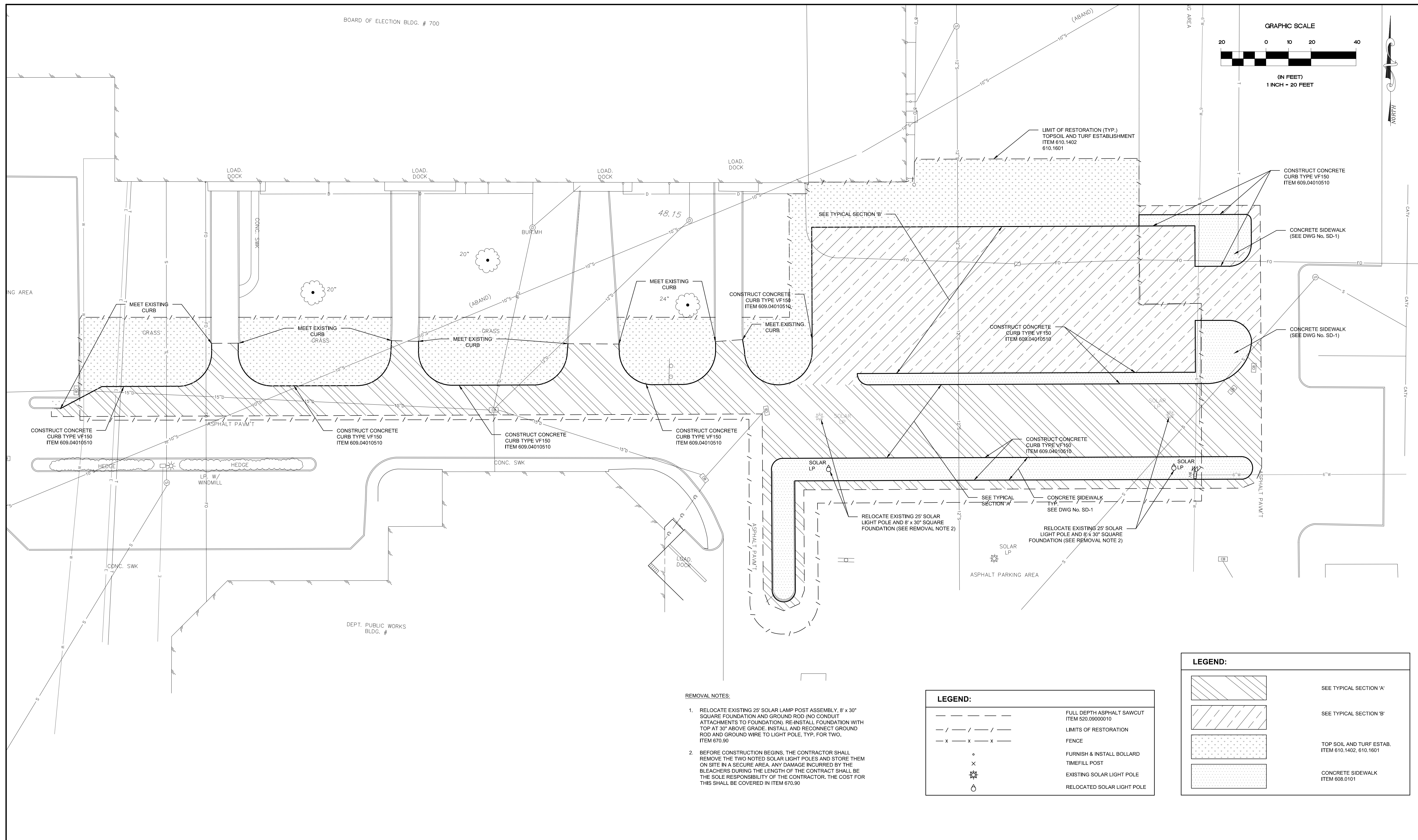

BOARD OF ELECTION BLDG. # 700

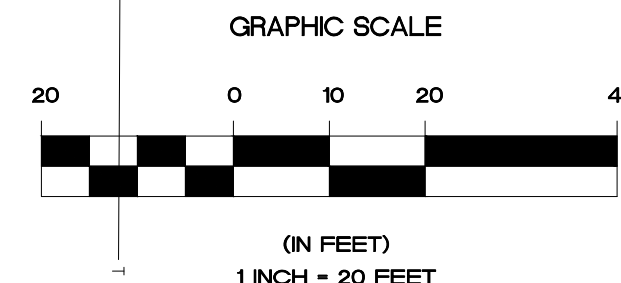

NG AREA

LOAD DOCK

LOAD DOCK

LOAD DOCK

LOAD DOCK

LIMIT OF RESTORATION (TYP.)  
TOPSOIL AND TURF ESTABLISHMENT  
ITEM 610.1402  
610.1601

CONSTRUCT CONCRETE  
CURB TYPE VF150  
ITEM 609.04010510

CONCRETE SIDEWALK  
(SEE DWG No. SD-1)

CONCRETE SIDEWALK  
(SEE DWG No. SD-1)

SEE TYPICAL SECTION 'B'

CONSTRUCT CONCRETE  
CURB TYPE VF150  
ITEM 609.04010510

CONSTRUCT CONCRETE  
CURB TYPE VF150  
ITEM 609.04010510

CONSTRUCT CONCRETE  
CURB TYPE VF150  
ITEM 609.04010510

CONSTRUCT CONCRETE  
CURB TYPE VF150  
ITEM 609.04010510

CONSTRUCT CONCRETE  
CURB TYPE VF150  
ITEM 609.04010510

CONSTRUCT CONCRETE  
CURB TYPE VF150  
ITEM 609.04010510

CONSTRUCT CONCRETE  
CURB TYPE VF150  
ITEM 609.04010510

HEDGE

LF W/  
WINDMILL

CONC. SWK

LOAD DOCK

ASPHALT PAVMT

RELOCATE EXISTING 25' SOLAR  
LIGHT POLE AND 8' x 30" SQUARE  
FOUNDATION (SEE REMOVAL NOTE 2)

RELOCATE EXISTING 25' SOLAR  
LIGHT POLE AND 8' x 30" SQUARE  
FOUNDATION (SEE REMOVAL NOTE 2)

ASPHALT PARKING AREA

DEPT. PUBLIC WORKS  
BLDG. #

**REMOVAL NOTES:**

1. RELOCATE EXISTING 25' SOLAR LAMP POST ASSEMBLY, 8' x 30" SQUARE FOUNDATION AND GROUND ROD (NO CONDUIT ATTACHMENTS TO FOUNDATION). RE-INSTALL FOUNDATION WITH TOP AT 30" ABOVE GRADE. INSTALL AND RECONNECT GROUND ROD AND GROUND WIRE TO LIGHT POLE, TYP. FOR TWO. ITEM 670.90
2. BEFORE CONSTRUCTION BEGINS, THE CONTRACTOR SHALL REMOVE THE TWO NOTED SOLAR LIGHT POLES AND STORE THEM ON SITE IN A SECURE AREA. ANY DAMAGE INCURRED BY THE BLEACHERS DURING THE LENGTH OF THE CONTRACT SHALL BE THE SOLE RESPONSIBILITY OF THE CONTRACTOR. THE COST FOR THIS SHALL BE COVERED IN ITEM 670.90

**LEGEND:**

---	FULL DEPTH ASPHALT SAWCUT ITEM 520.09000010
- - - - -	LIMITS OF RESTORATION
- x - x - x -	FENCE
o	FURNISH & INSTALL BOLLARD
x	TIMEFILL POST
☼	EXISTING SOLAR LIGHT POLE
⊙	RELOCATED SOLAR LIGHT POLE

**LEGEND:**

	SEE TYPICAL SECTION 'A'
	SEE TYPICAL SECTION 'B'
	TOP SOIL AND TURF ESTAB. ITEM 610.1402, 610.1601
	CONCRETE SIDEWALK ITEM 608.0101

No.	DATE	REVISION	BY:
1	2/1/2013	90% SET ISSUED FOR SCDPWNYSDOT REVIEW	JDN/RP

THIS DOCUMENT IS THE SOLE PROPERTY OF N&P ENGINEERS & SURVEYORS, PLLC, AND HAS BEEN PREPARED AND DISSEMINATED FOR THE SOLE USE OF OUR CLIENT. THIS DOCUMENT AND ANY DATA, CALCULATIONS, ESTIMATES OR DEVIATIONS CONTAINED HEREIN, MAY NOT BE UTILIZED BY ANY THIRD PARTY WITHOUT PRIOR WRITTEN CONSENT OF N&P ENGINEERS & SURVEYORS, PLLC, WHICH ASSUMES NO RISK OF LOSS OR LIABILITY RESULTING FROM ANY UNAUTHORIZED USE OR RELIANCE BY ANY THIRD PARTY.

CONSULTANT:

**NELSON & POPE**  
ENGINEERS • SURVEYORS  
572 WALT WHITMAN ROAD, MELVILLE, N.Y. 11747-2188  
(631) 427-5665 FAX (631) 427-5620  
WWW.NELSONPOPE.COM

CLIENT:

**SUFFOLK COUNTY DEPARTMENT OF PUBLIC WORKS**  
335 YAPHANK AVENUE  
YAPHANK, NEW YORK 11980

DWN. BY: JD  
CHKD BY: JRP  
DATE: FEBRUARY 2013  
JOB No.: 12120  
CADD: 12120SITE  
SCALE: AS SHOWN

DRAWING TITLE:

**SITE PLAN - 2  
BID ALTERNATE 'D'  
NEW COMPRESSED NATURAL GAS FILLING STATION  
SUFFOLK COUNTY - YAPHANK COMPLEX  
CP 5603.110 PIN 0759.61**

DRAWING NUMBER:

**SP-2**

SHEET: 8 OF 26

## L A I D O N T H E T A B L E M A R C H 1 9 , 2 0 1 3

LADS REPORT PREPARED BY:

Michele Gerardi

(Revised 3/20/2013)

- Type II Action  
6 NYCRR 617.5(c)  
(20)(27) 1208. Adopting Local Law No. -2013, A Charter Law to clarify employee residency requirements. (Cilmi) GOVERNMENT OPERATIONS, PERSONNEL, HOUSING & CONSUMER PROTECTION
- Type II Action  
6 NYCRR 617.5(c)  
(20)(27) 1209. Authorizing illumination of the H. Lee Dennison Executive Office Building for Judy's Run for Stroke Awareness. (Kennedy) PUBLIC WORKS AND TRANSPORTATION
- Type II Action  
6 NYCRR 617.5(c)  
(20)(27) 1210. To readjust, compromise, and grant refunds and chargebacks on correction or errors/County Treasurer By: County Legislature No. 387. (Co. Exec.) BUDGET AND FINANCE
- Type II Action  
6 NYCRR 617.5(c)  
(20)(27) 1211. To readjust, compromise, and grant refunds and chargebacks on correction or errors/County Treasurer By: County Legislature No. 388. (Co. Exec.) BUDGET AND FINANCE
- Type II Action  
6 NYCRR 617.5(c)  
(20)(27) 1212. To readjust, compromise, and grant refunds and chargebacks on correction or errors/County Treasurer By: County Legislature No. 389. (Co. Exec.) BUDGET AND FINANCE
- Type II Action  
6 NYCRR 617.5(c)  
(20)(27) 1213. To readjust, compromise, and grant refunds and charge-backs on real property correction of errors by: County Legislature (Control No. 920-2013). (Co. Exec.) BUDGET AND FINANCE
- SEQRA Completed  
by Reso. 716-2004 1214. Appropriating funds through the issuance of Sewer District Serial Bonds for the increase, improvement and extension to Suffolk County Sewer District No. 18 - Hauppauge Industrial (CP 8126). (Co. Exec.) PUBLIC WORKS AND TRANSPORTATION
- Type II Action  
6 NYCRR 617.5(c)  
(11)(20)(27) 1215. Authorizing execution of an agreement by the Administrative Head of SCSD No. 3 - Southwest with WR Communities - A LLC (BA-1477.1-002). (Co. Exec.) PUBLIC WORKS AND TRANSPORTATION
- Type II Action  
6 NYCRR 617.5(c)  
(11)(20)(27) 1216. Authorizing execution of an agreement by the Administrative Head of SCSD No. 3 - Southwest with WR Communities - B LLC (BA-1477.1-003). (Co. Exec.) PUBLIC WORKS AND TRANSPORTATION
- Type II Action  
6 NYCRR 617.5(c)  
(20)(27) 1217. Accepting and appropriating 100% Federal grant funds from the National Association of County and City Health Officials (NACCHO) to the Department of Health Services for the implementation of Emergency Preparedness Strategies for Community-Dwelling Older Adults. (Co. Exec.) HEALTH
- Type II Action  
6 NYCRR 617.5(c)  
(20)(27) 1218. To readjust, compromise, and grant refunds and charge-backs on real property correction of errors by: County Legislature (Control No. 921-2013). (Co. Exec.) BUDGET AND FINANCE

- Unlisted Action 1219. Authorizing the sale, pursuant to Local Law No. 16-1976, of real property acquired under Section 46 of the Suffolk County Tax Act John B. Gallagher (SCTM No. 0900-145.00-02.00-054.000). (Co. Exec.) WAYS & MEANS
- Unlisted Action 1220. Authorizing the sale, pursuant to Local Law No. 16-1976, of real property acquired under Section 46 of the Suffolk County Tax Act Estate of Blanche Bray (SCTM No. 0100-055.00-01.00-052.000). (Co. Exec.) WAYS & MEANS
- Unlisted Action 1221. Authorizing the sale, pursuant to Local Law No. 16-1976, of real property acquired under Section 46 of the Suffolk County Tax Act Frank Musarra and Josephine Musarra, his wife (SCTM No. 0200-626.00-02.00-022.000). (Co. Exec.) WAYS & MEANS
- Unlisted Action 1222. Authorizing the sale, pursuant to Local Law No. 16-1976, of real property acquired under Section 46 of the Suffolk County Tax Act Alfredo Campos and Ruth Campos (SCTM No. 0101-003.00-02.00-010.000). (Co. Exec.) WAYS & MEANS
- Unlisted Action 1223. Authorizing the sale, pursuant to Local Law No. 16-1976, of real property acquired under Section 46 of the Suffolk County Tax Act Dale Rosgaard (SCTM No. 0200-692.00-04.00-038.001). (Co. Exec.) WAYS & MEANS
- Unlisted Action 1224. Authorizing the sale, pursuant to Local Law No. 16-1976, of real property acquired under Section 46 of the Suffolk County Tax Act Lychee Management Group, Inc. (SCTM No. 0200-761.00-05.00-057.000). (Co. Exec.) WAYS & MEANS
- Unlisted Action 1225. Authorizing the sale, pursuant to Local Law No. 16-1976, of real property acquired under Section 46 of the Suffolk County Tax Act Timber Ridge Homes at Mount Sinai Homeowners Association, Inc. (SCTM No. 0200-142.00-04.00-001.055). (Co. Exec.) WAYS & MEANS
- Unlisted Action 1226. Authorizing the sale, pursuant to Local Law No. 16-1976, of real property acquired under Section 46 of the Suffolk County Tax Act Michael Grottola and Linda Grottola, husband and wife (SCTM No. 0200-695.00-01.00-006.000). (Co. Exec.) WAYS & MEANS
- Unlisted Action 1227. Sale of County-owned real estate pursuant to Local Law No. 13-1976 Renee M. Wunsch and Charles A. Powell, as joint tenants with rights of survivorship (SCTM No. 0200-867.00-06.00-037.000). (Co. Exec.) WAYS & MEANS
- Unlisted Action 1228. Authorizing the sale, pursuant to Local Law No. 16-1976, of real property acquired under Section 46 of the Suffolk County Tax Act Ronald Smith, as Administrator of the Estate of Dorothy May Smith (SCTM No. 0900-070.00-02.00-033.000). (Co. Exec.) WAYS & MEANS
- Unlisted Action 1229. Authorizing the sale, pursuant to Local Law No. 16-1976, of real property acquired under Section 46 of the Suffolk County Tax Act John Gerrato (SCTM No. 0103-010.00-01.00-022.000). (Co. Exec.) WAYS & MEANS

- Unlisted Action 1230. Authorizing the sale of County-owned real property pursuant to Section 72-h of the General Municipal Law to the Town of Brookhaven for Affordable Housing Purpose (SCTM No. 0200-069.00-08.00-007.001). (Co. Exec.) GOVERNMENT OPERATIONS, PERSONNEL, HOUSING & CONSUMER PROTECTION
- Unlisted Action 1231. Sale of County-owned real estate pursuant to Section 72-h of the General Municipal Law - Town of Brookhaven (SCTM No. 0200-256.00-05.00-037.000). (Co. Exec.) WAYS & MEANS
- Type II Action  
6 NYCRR 617.5(c)  
(20)(27) 1232. Authorizing the granting of a permanent easement to the Suffolk County Water Authority for production, distribution and transmission of drinking water on a parcel acquired by the County of Suffolk under the Old Drinking Water Protection Program – (Aldrich Lane, Mattituck New York bearing SCTM No. 1000-125.00-01.00-001.000). (Co. Exec.) ENVIRONMENT, PLANNING AND AGRICULTURE
- Type II Action  
6 NYCRR 617.5(c)  
(20)(27) 1233. Directing the Department of Social Services to implement an Emergency Housing Policy that will benefit homeless children. (Gregory) HUMAN SERVICES
- Type II Action  
6 NYCRR 617.5(c)  
(20)(25)(27) 1234. Appropriating funds in connection with the acquisition of a Suffolk County Telephony Structural Improvements (CP 1814). (Co. Exec.) \*\*WITHDRAWN AS OF 3/18/2013\*\*
- Type II Action  
6 NYCRR 617.5(c)  
(20)(25)(27) 1235. Appropriating funds in connection with the acquisition of an IFMS Release 3 (CP 1782). (Co. Exec.) EDUCATION AND INFORMATION TECHNOLOGY
- Type II Action  
6 NYCRR 617.5(c)  
(20)(25)(27) 1236. Appropriating funds in connection with the acquisition of a Disaster Recovery Project (CP 1729). (Co. Exec.) EDUCATION AND INFORMATION TECHNOLOGY
- Type II Action  
6 NYCRR 617.5(c)  
(20)(25)(27) 1237. Appropriating funds in connection with the acquisition of Fiber Cabling Network and WAN Technology Upgrades (CP 1726). (Co. Exec.) EDUCATION AND INFORMATION TECHNOLOGY
- Type II Action  
6 NYCRR 617.5(c)  
(20)(25)(27) 1238. Appropriating funds in connection with the acquisition and implementation of a District Attorney Case Management System (CP 1136). (Co. Exec.) \*\*WITHDRAWN AS OF 3/18/2013\*\*
- Type II Action  
6 NYCRR 617.5(c)  
(2)(20)(25)(27) 1239. Appropriating funds in connection with the replacement of existing Fireworks Burn Pits (CP 3016). (Co. Exec.) \*\*WITHDRAWN AS OF 3/18/2013\*\*
- Type II Action  
6 NYCRR 617.5(c)  
(20)(25)(27) 1240. Appropriating funds in connection with the purchase of heavy duty vehicles for the Police Department (CP 3135). (Co. Exec.) PUBLIC SAFETY
- Type II Action  
6 NYCRR 617.5(c)  
(20)(25)(27) 1241. Appropriating funds in connection with the purchase of Marine Bureau Diesel Engines (CP 3198). (Co. Exec.) PUBLIC SAFETY
- Type II Action  
6 NYCRR 617.5(c)  
(20)(25)(27) 1242. Appropriating funds in connection with the replacement of Police Headquarters 911 Backup Generator (CP 3216). (Co. Exec.) \*\*WITHDRAWN AS OF 3/18/2013\*\*

- Type II Action  
6 NYCRR 617.5(c)  
(2)(20)(27) 1243. Appropriating funds in connection with the replacement of existing shower facilities in the Police Emergency Services Section Building (CP 3232). (Co. Exec.) PUBLIC SAFETY
- Type II Action  
6 NYCRR 617.5(c)  
(20)(27) 1244. Amending the Operating Budget of the Department of Civil Service/Human Resources to add two Clerk Typist positions. (Co. Exec.) GOVERNMENT OPERATIONS, PERSONNEL, HOUSING & CONSUMER PROTECTION
- Type II Action  
6 NYCRR 617.5(c)  
(20)(27) 1245. Accepting and appropriating 100% Federal funds awarded by the U.S. Marshals Service to the Suffolk County Department of Probation and authorizing the County Executive to execute related agreements. (Co. Exec.) PUBLIC SAFETY
- Type II Action  
6 NYCRR 617.5(c)  
(20)(27) 1246. Accepting and appropriating 100% Federal funds awarded as pass-thru funding by the New York State Division of Criminal Justice Services to the Suffolk County Department of Probation and authorizing the County Executive to execute related agreements. (Co. Exec.) PUBLIC SAFETY
- Type II Action  
6 NYCRR 617.5(c)  
(20)(27) 1247. Confirming appointment of County Director of Probation (Patrice Dlhopsky). (Co. Exec.) PUBLIC SAFETY
- Type II Action  
6 NYCRR 617.5(c)  
(20)(27) 1248. Clarifying rules for distribution of public safety revenue sharing monies to towns and villages. (Schneiderman) PUBLIC SAFETY
- SEQRA previously completed by Town 1249. Bond Resolution of the County of Suffolk, New York, authorizing the issuance of \$313,000 in bonds to finance the cost of infrastructure improvements under the Suffolk County Affordable Housing Opportunities Program (Summerwind Square – Riverhead) (CP 6411). (Co. Exec.) GOVERNMENT OPERATIONS, PERSONNEL, HOUSING & CONSUMER PROTECTION
- Type II Action  
6 NYCRR 617.5(c)  
(20)(27) 1250. Adopting Local Law No. -2013, A Local Law to enhance and improve Suffolk County's E-911 Service. (Kennedy) PUBLIC SAFETY
- Type II Action  
6 NYCRR 617.5(c)  
(20)(27) 1251. Amending the 2013 Adopted Operating Budget to transfer funding from Brentwood Union Free School District (UFSD) and the Town of Islip-ACCESS/ACCESSO programs to various agencies for the provision of chemical dependency services. (Co. Exec.) HEALTH
- Type II Action  
6 NYCRR 617.5(c)  
(20)(27) 1252. Authorizing transfer of property to the Department of Parks, Recreation and Conservation. (Kennedy) WAYS & MEANS
- Type II Action  
6 NYCRR 617.5(c)  
(20)(27) 1253. Establishing an Educational Outreach Program on the economic value of Cultural Arts. (Hahn) ECONOMIC DEVELOPMENT AND ENERGY
- Type II Action  
6 NYCRR 617.5(c)  
(20)(27) 1254. Amending Chapter 1070 of the Code of Suffolk County for Real Estate appraisal, acquisition and disposition, and implementing the "Triple A" acquisition procedure. (Co. Exec.) WAYS & MEANS
- Type II Action  
6 NYCRR 617.5(c)  
(20)(27) 1255. Terminating the County's contract with CMS Compliance Group. (Muratore) HEALTH

**PROCEDURAL MOTION**

Type II Action  
6 NYCRR 617.5(c)  
(20)(27)

PM07.

To renew agreement with PFM Asset Management LLC. (Pres. Off.) PARKS & RECREATION

**CEQ RESOLUTION NO. 18-2013, AUTHORIZING ADOPTION OF MARCH 20,  
2013 CEQ MINUTES**

**WHEREAS**, the Council on Environmental Quality has received and reviewed the March 20, 2013 meeting minutes; now, therefore, be it

**1<sup>st</sup> RESOLVED**, that a quorum of the Council on Environmental Quality, having heard and accepted all comments and necessary corrections hereby adopts the meeting minutes of March 20, 2013

DATED: 4/17/2013

PROJECT #: Adoption of Minutes  
RESOLUTION #: 18-2013  
DATE: April 17, 2013

RECORD OF CEQ RESOLUTION VOTES

<u>CEQ APPOINTED MEMBERS</u>	<u>AYE</u>	<u>NAY</u>	<u>ABSTAIN</u>	<u>NOT PRESENT</u>	<u>RECUSED</u>
James Bagg	<input checked="" type="checkbox"/>	<input type="checkbox"/>	<input type="checkbox"/>	<input type="checkbox"/>	<input type="checkbox"/>
Eva Growney	<input type="checkbox"/>	<input type="checkbox"/>	<input type="checkbox"/>	<input checked="" type="checkbox"/>	<input type="checkbox"/>
Thomas C. Gulbransen	<input checked="" type="checkbox"/>	<input type="checkbox"/>	<input type="checkbox"/>	<input type="checkbox"/>	<input type="checkbox"/>
Hon. Kara Hahn	<input type="checkbox"/>	<input type="checkbox"/>	<input type="checkbox"/>	<input checked="" type="checkbox"/>	<input type="checkbox"/>
Michael Kaufman	<input checked="" type="checkbox"/>	<input type="checkbox"/>	<input type="checkbox"/>	<input type="checkbox"/>	<input type="checkbox"/>
Richard Machtay	<input type="checkbox"/>	<input type="checkbox"/>	<input checked="" type="checkbox"/>	<input type="checkbox"/>	<input type="checkbox"/>
Daniel Pichney	<input type="checkbox"/>	<input type="checkbox"/>	<input checked="" type="checkbox"/>	<input type="checkbox"/>	<input type="checkbox"/>
Gloria G. Russo	<input type="checkbox"/>	<input type="checkbox"/>	<input checked="" type="checkbox"/>	<input type="checkbox"/>	<input type="checkbox"/>
Mary Ann Spencer	<input checked="" type="checkbox"/>	<input type="checkbox"/>	<input type="checkbox"/>	<input type="checkbox"/>	<input type="checkbox"/>
Larry Swanson	<input checked="" type="checkbox"/>	<input type="checkbox"/>	<input type="checkbox"/>	<input type="checkbox"/>	<input type="checkbox"/>
<u>CAC REPRESENTATIVES</u>	<input type="checkbox"/>	<input type="checkbox"/>	<input type="checkbox"/>	<input type="checkbox"/>	<input type="checkbox"/>

Recommendation: Adoption of minutes

Motion: Mr. Kaufman

Second: Mr. Bagg

Further information may be obtained by contacting:

Andrew P. Freleng, Chief Planner  
Council on Environmental Quality  
P.O. Box 6100  
Hauppauge, New York 11788  
Tel: (631) 853-5191



# COUNTY OF SUFFOLK



STEVEN BELLONE  
COUNTY EXECUTIVE

DEPARTMENT OF ECONOMIC DEVELOPMENT AND PLANNING  
DIVISION OF PLANNING AND ENVIRONMENT  
COUNCIL ON ENVIRONMENTAL QUALITY

GLORIA RUSSO  
CHAIRPERSON  
CEQ

## MEMORANDUM

TO: Honorable Steven Bellone, Suffolk County Executive  
Honorable William J. Lindsay, Presiding Officer

FROM: Gloria Russo, Chairperson *GR cd*

DATE: April 18, 2013

RE: CEQ Review of the Proposed CP# 5603 – Yaphank CNG Fueling Facility, Town of Brookhaven

---

At its April 17, 2013 meeting, the CEQ reviewed the above referenced matter. Pursuant to Chapter 450 of the Suffolk County Code, and based on the information received, as well as that given in a presentation by Raymond Muxo, Associate Mechanical Engineer, Suffolk County Department of Public Works, the Council advises the Suffolk County Legislature and County Executive, in CEQ Resolution No. 19-2013, a copy of which is attached, that the proposed project be considered an Unlisted Action under SEQRA that will not have significant adverse impacts on the environment.

If the Legislature concurs with the Council on Environmental Quality's recommendation that the projects will not have a significant adverse impact on the environment, the Presiding Officer should cause to be brought before the Legislature for a vote, a resolution determining that the proposed action is an Unlisted Action pursuant to SEQRA that will not have significant adverse impacts on the environment (negative declaration). However, if the Legislature has further environmental concerns regarding this project and needs additional information, the Presiding Officer should remand the case back to the initiating unit for the necessary changes to the project and EAF or submit a resolution authorizing the initiating unit to prepare a draft environmental impact statement (positive declaration).

Enclosed for your information is a copy of CEQ Resolution No. 19-2013 which sets forth the Council's recommendations. The project EAF and supporting documentation can be viewed online at <http://www.suffolkcountyny.gov/Departments/Planning/Boards/CouncilonEnvironmentalQuality>  
If the Council can be of further help in this matter, please let us know.

Enc.

cc: All Suffolk County Legislators  
Tim Laube, Clerk of Legislature  
George Nolan, Attorney for the Legislature  
Sarah Lansdale, Director of Planning, Department of Economic Development and Planning  
Andrew Freleng, Chief Planner, Department of Economic Development and Planning  
Dennis Brown, Suffolk County Attorney

**CEQ RESOLUTION NO. 19-2013, RECOMMENDATION CONCERNING A SEQRA CLASSIFICATION AND DETERMINATION FOR THE PURPOSES OF CHAPTER 450 OF THE SUFFOLK COUNTY CODE FOR THE PROPOSED CP# 5603 – YAPHANK CNG FUELING FACILITY, TOWN OF BROOKHAVEN**

**WHEREAS**, at its April 17, 2013 meeting, the Suffolk County Council on Environmental Quality (CEQ) reviewed the EAF and associated information submitted by the Suffolk County Department of Public Works; and

**WHEREAS**, a presentation regarding the project was given at the meeting by Raymond Muxo, Associate Mechanical Engineer, Suffolk County Department of Public Works; and

**WHEREAS**, the project involves the construction of Compressed Natural Gas (CNG) Fueling Facility; now, therefore, be it

**1<sup>st</sup> RESOLVED**, that based on the information received and presented, a quorum of the CEQ hereby recommends to the Suffolk County Legislature and County Executive that the proposed activity be classified as an Unlisted Action under the provisions of Title 6 NYCRR Part 617 and Chapter 450 of the Suffolk County Code; and, be it further

**2<sup>nd</sup> RESOLVED**, that based on the information received, a quorum of the CEQ recommends to the Suffolk County Legislature and County Executive, pursuant to Title 6 NYCRR Part 617 and Chapter 450 of the Suffolk County Code, that the proposed project will not have significant adverse impacts on the environment for the following reasons:

1. The proposed action will not exceed any of the criteria in Title 6 NYCRR Part 617.7, which sets forth thresholds for determining significant effect on the environment, as demonstrated in the Environmental Assessment Form;
2. The proposal does not significantly threaten any unique or highly valuable environmental or cultural resources as identified in or regulated by the Environmental Conservation Law of the State of New York or the Suffolk County Charter and Code;
3. The parcel does not appear to suffer from any severe environmental development constraints (limiting soil properties; no high groundwater and no unmanageable slopes);
4. The Suffolk County Department of Public Works will coordinate with Suffolk County Department of Parks, Recreation and Conservation during clearing to observe and preserve any artifacts which may be encountered;
5. All local fire codes and State regulations governing the CNG Fueling Facility will be adhered to;

and, be it further

**3<sup>rd</sup> RESOLVED**, that it is the recommendation of the Council that the Legislature and County Executive adopt a SEQRA determination of non-significance (negative declaration).

DATED: 4/17/2013

PROJECT #: DPW-16-2013  
RESOLUTION #: 19-2013  
DATE: April 17, 2013

RECORD OF CEQ RESOLUTION VOTES

<u>CEQ APPOINTED MEMBERS</u>	<u>AYE</u>	<u>NAY</u>	<u>ABSTAIN</u>	<u>NOT PRESENT</u>	<u>RECUSED</u>
James Bagg	<input checked="" type="checkbox"/>	<input type="checkbox"/>	<input type="checkbox"/>	<input type="checkbox"/>	
Eva Growney	<input checked="" type="checkbox"/>	<input type="checkbox"/>	<input type="checkbox"/>	<input type="checkbox"/>	
Thomas C. Gulbransen	<input checked="" type="checkbox"/>	<input type="checkbox"/>	<input type="checkbox"/>	<input type="checkbox"/>	
Hon. Kara Hahn	<input type="checkbox"/>	<input type="checkbox"/>	<input type="checkbox"/>	<input checked="" type="checkbox"/>	
Michael Kaufman	<input checked="" type="checkbox"/>	<input type="checkbox"/>	<input type="checkbox"/>	<input type="checkbox"/>	
Richard Machtay	<input checked="" type="checkbox"/>	<input type="checkbox"/>	<input type="checkbox"/>	<input type="checkbox"/>	
Daniel Pichney	<input checked="" type="checkbox"/>	<input type="checkbox"/>	<input type="checkbox"/>	<input type="checkbox"/>	
Gloria G. Russo	<input checked="" type="checkbox"/>	<input type="checkbox"/>	<input type="checkbox"/>	<input type="checkbox"/>	
Mary Ann Spencer	<input checked="" type="checkbox"/>	<input type="checkbox"/>	<input type="checkbox"/>	<input type="checkbox"/>	
Larry Swanson	<input checked="" type="checkbox"/>	<input type="checkbox"/>	<input type="checkbox"/>	<input type="checkbox"/>	
<u>CAC REPRESENTATIVES</u>	<input type="checkbox"/>	<input type="checkbox"/>	<input type="checkbox"/>	<input type="checkbox"/>	

Recommendation: Unlisted Action, Negative Declaration

Motion: Mr. Kaufman

Second: Ms. Growney

Further information may be obtained by contacting:

Andrew P. Freleng, Chief Planner  
Council on Environmental Quality  
P.O. Box 6100  
Hauppauge, New York 11788  
Tel: (631) 853-5191

# COUNTY OF SUFFOLK



STEVEN BELLONE  
COUNTY EXECUTIVE

DEPARTMENT OF ECONOMIC DEVELOPMENT AND PLANNING  
DIVISION OF PLANNING AND ENVIRONMENT  
COUNCIL ON ENVIRONMENTAL QUALITY

GLORIA RUSSO  
CHAIRPERSON  
CEQ

## MEMORANDUM

TO: Honorable Steven Bellone, Suffolk County Executive  
Honorable William J. Lindsay, Presiding Officer

FROM: Gloria Russo, Chairperson *GR*

DATE: April 18, 2013

RE: CEQ Review of the Recommended SEQRA Classifications of Legislative Resolutions  
Laid on the Table March 19, 2013

---

At its April 17, 2013 meeting, the CEQ reviewed the above referenced matter. Pursuant to Chapter 450 of the Suffolk County Code, and based on the information received, the Council recommends to the Suffolk County Legislature and County Executive in CEQ Resolution No. 20-2013, a copy of which is attached, that the enclosed list of legislative resolutions laid on the table March 19, 2013, be classified pursuant to SEQRA as so indicated in the left hand margin. The majority of the proposed resolutions are Type II actions pursuant to the appropriate section of Title 6 NYCRR Part 617.5, with no further environmental review necessary. Unlisted and Type I actions require that the initiating unit of County government prepare an Environmental Assessment Form (EAF) and submit it to the CEQ for further SEQRA review and recommendations.

Enclosed for your information is a copy of CEQ Resolution No. 20-2013 setting forth the Council's recommendations along with the associated list of legislative resolutions. If the Council can be of further help in this matter, please let us know.

Enc.

cc: All Suffolk County Legislators  
Tim Laube, Clerk of Legislature  
George Nolan, Attorney for the Legislature  
Sarah Lansdale, Director of Planning, Department of Economic Development and Planning  
Andrew Freleng, Chief Planner, Department of Economic Development and Planning  
Dennis Brown, Suffolk County Attorney

**CEQ RESOLUTION NO. 20-2013, RECOMMENDATION CONCERNING SEQRA CLASSIFICATIONS OF LEGISLATIVE RESOLUTIONS LAID ON THE TABLE MARCH 19, 2013 PURSUANT TO CHAPTER 450 OF THE SUFFOLK COUNTY CODE**

**WHEREAS**, the legislative packet regarding resolutions laid on the table March 19, 2013 has been received in the CEQ office; and

**WHEREAS**, staff has preliminarily reviewed the proposed resolutions and recommended SEQRA classifications; now, therefore, be it

**1<sup>st</sup> RESOLVED**, that in the judgment of the CEQ, based on the information received and presented, a quorum of the Council recommends to the Suffolk County Legislature and County Executive, pursuant to Chapter 450 of the Suffolk County Code, that the attached list of actions and projects be classified by the Legislature and County Executive pursuant to SEQRA as so indicated.

DATED: 4/17/2013

PROJECT #: PLN-15-2013  
RESOLUTION #: 20-2013  
DATE: April 17, 2013

RECORD OF CEQ RESOLUTION VOTES

<u>CEQ APPOINTED MEMBERS</u>	<u>AYE</u>	<u>NAY</u>	<u>ABSTAIN</u>	<u>NOT PRESENT</u>	<u>RECUSED</u>
James Bagg	<input checked="" type="checkbox"/>	<input type="checkbox"/>	<input type="checkbox"/>	<input type="checkbox"/>	
Eva Gowney	<input checked="" type="checkbox"/>	<input type="checkbox"/>	<input type="checkbox"/>	<input type="checkbox"/>	
Thomas C. Gulbransen	<input checked="" type="checkbox"/>	<input type="checkbox"/>	<input type="checkbox"/>	<input type="checkbox"/>	
Hon. Kara Hahn	<input type="checkbox"/>	<input type="checkbox"/>	<input type="checkbox"/>	<input checked="" type="checkbox"/>	
Michael Kaufman	<input checked="" type="checkbox"/>	<input type="checkbox"/>	<input type="checkbox"/>	<input type="checkbox"/>	
Richard Machtay	<input checked="" type="checkbox"/>	<input type="checkbox"/>	<input type="checkbox"/>	<input type="checkbox"/>	
Daniel Pichney	<input checked="" type="checkbox"/>	<input type="checkbox"/>	<input type="checkbox"/>	<input type="checkbox"/>	
Gloria G. Russo	<input checked="" type="checkbox"/>	<input type="checkbox"/>	<input type="checkbox"/>	<input type="checkbox"/>	
Mary Ann Spencer	<input checked="" type="checkbox"/>	<input type="checkbox"/>	<input type="checkbox"/>	<input type="checkbox"/>	
Larry Swanson	<input checked="" type="checkbox"/>	<input type="checkbox"/>	<input type="checkbox"/>	<input type="checkbox"/>	
<u>CAC REPRESENTATIVES</u>	<input type="checkbox"/>	<input type="checkbox"/>	<input type="checkbox"/>	<input type="checkbox"/>	

Motion: Mr. Kaufman

Second: Mr. Gulbransen

Further information may be obtained by contacting:

Andrew P. Freleng, Chief Planner  
Council on Environmental Quality  
P.O. Box 6100  
Hauppauge, New York 11788  
Tel: (631) 853-5191

## L A I D O N T H E T A B L E M A R C H 1 9 , 2 0 1 3

LADS REPORT PREPARED BY:

Michele Gerardi

(Revised 3/20/2013)

- Type II Action  
6 NYCRR 617.5(c)  
(20)(27) 1208. Adopting Local Law No. -2013, A Charter Law to clarify employee residency requirements. (Cilmi) GOVERNMENT OPERATIONS, PERSONNEL, HOUSING & CONSUMER PROTECTION
- Type II Action  
6 NYCRR 617.5(c)  
(20)(27) 1209. Authorizing illumination of the H. Lee Dennison Executive Office Building for Judy's Run for Stroke Awareness. (Kennedy) PUBLIC WORKS AND TRANSPORTATION
- Type II Action  
6 NYCRR 617.5(c)  
(20)(27) 1210. To readjust, compromise, and grant refunds and chargebacks on correction or errors/County Treasurer By: County Legislature No. 387. (Co. Exec.) BUDGET AND FINANCE
- Type II Action  
6 NYCRR 617.5(c)  
(20)(27) 1211. To readjust, compromise, and grant refunds and chargebacks on correction or errors/County Treasurer By: County Legislature No. 388. (Co. Exec.) BUDGET AND FINANCE
- Type II Action  
6 NYCRR 617.5(c)  
(20)(27) 1212. To readjust, compromise, and grant refunds and chargebacks on correction or errors/County Treasurer By: County Legislature No. 389. (Co. Exec.) BUDGET AND FINANCE
- Type II Action  
6 NYCRR 617.5(c)  
(20)(27) 1213. To readjust, compromise, and grant refunds and charge-backs on real property correction of errors by: County Legislature (Control No. 920-2013). (Co. Exec.) BUDGET AND FINANCE
- SEQRA Completed  
by Reso. 716-2004 1214. Appropriating funds through the issuance of Sewer District Serial Bonds for the increase, improvement and extension to Suffolk County Sewer District No. 18 - Hauppauge Industrial (CP 8126). (Co. Exec.) PUBLIC WORKS AND TRANSPORTATION
- Type II Action  
6 NYCRR 617.5(c)  
(11)(20)(27) 1215. Authorizing execution of an agreement by the Administrative Head of SCSD No. 3 - Southwest with WR Communities - A LLC (BA-1477.1-002). (Co. Exec.) PUBLIC WORKS AND TRANSPORTATION
- Type II Action  
6 NYCRR 617.5(c)  
(11)(20)(27) 1216. Authorizing execution of an agreement by the Administrative Head of SCSD No. 3 - Southwest with WR Communities - B LLC (BA-1477.1-003). (Co. Exec.) PUBLIC WORKS AND TRANSPORTATION
- Type II Action  
6 NYCRR 617.5(c)  
(20)(27) 1217. Accepting and appropriating 100% Federal grant funds from the National Association of County and City Health Officials (NACCHO) to the Department of Health Services for the implementation of Emergency Preparedness Strategies for Community-Dwelling Older Adults. (Co. Exec.) HEALTH
- Type II Action  
6 NYCRR 617.5(c)  
(20)(27) 1218. To readjust, compromise, and grant refunds and charge-backs on real property correction of errors by: County Legislature (Control No. 921-2013). (Co. Exec.) BUDGET AND FINANCE

- Unlisted Action 1219. Authorizing the sale, pursuant to Local Law No. 16-1976, of real property acquired under Section 46 of the Suffolk County Tax Act John B. Gallagher (SCTM No. 0900-145.00-02.00-054.000). (Co. Exec.) WAYS & MEANS
- Unlisted Action 1220. Authorizing the sale, pursuant to Local Law No. 16-1976, of real property acquired under Section 46 of the Suffolk County Tax Act Estate of Blanche Bray (SCTM No. 0100-055.00-01.00-052.000). (Co. Exec.) WAYS & MEANS
- Unlisted Action 1221. Authorizing the sale, pursuant to Local Law No. 16-1976, of real property acquired under Section 46 of the Suffolk County Tax Act Frank Musarra and Josephine Musarra, his wife (SCTM No. 0200-626.00-02.00-022.000). (Co. Exec.) WAYS & MEANS
- Unlisted Action 1222. Authorizing the sale, pursuant to Local Law No. 16-1976, of real property acquired under Section 46 of the Suffolk County Tax Act Alfredo Campos and Ruth Campos (SCTM No. 0101-003.00-02.00-010.000). (Co. Exec.) WAYS & MEANS
- Unlisted Action 1223. Authorizing the sale, pursuant to Local Law No. 16-1976, of real property acquired under Section 46 of the Suffolk County Tax Act Dale Rosgaard (SCTM No. 0200-692.00-04.00-038.001). (Co. Exec.) WAYS & MEANS
- Unlisted Action 1224. Authorizing the sale, pursuant to Local Law No. 16-1976, of real property acquired under Section 46 of the Suffolk County Tax Act Lychee Management Group, Inc. (SCTM No. 0200-761.00-05.00-057.000). (Co. Exec.) WAYS & MEANS
- Unlisted Action 1225. Authorizing the sale, pursuant to Local Law No. 16-1976, of real property acquired under Section 46 of the Suffolk County Tax Act Timber Ridge Homes at Mount Sinai Homeowners Association, Inc. (SCTM No. 0200-142.00-04.00-001.055). (Co. Exec.) WAYS & MEANS
- Unlisted Action 1226. Authorizing the sale, pursuant to Local Law No. 16-1976, of real property acquired under Section 46 of the Suffolk County Tax Act Michael Grottola and Linda Grottola, husband and wife (SCTM No. 0200-695.00-01.00-006.000). (Co. Exec.) WAYS & MEANS
- Unlisted Action 1227. Sale of County-owned real estate pursuant to Local Law No. 13-1976 Renee M. Wunsch and Charles A. Powell, as joint tenants with rights of survivorship (SCTM No. 0200-867.00-06.00-037.000). (Co. Exec.) WAYS & MEANS
- Unlisted Action 1228. Authorizing the sale, pursuant to Local Law No. 16-1976, of real property acquired under Section 46 of the Suffolk County Tax Act Ronald Smith, as Administrator of the Estate of Dorothy May Smith (SCTM No. 0900-070.00-02.00-033.000). (Co. Exec.) WAYS & MEANS
- Unlisted Action 1229. Authorizing the sale, pursuant to Local Law No. 16-1976, of real property acquired under Section 46 of the Suffolk County Tax Act John Gerrato (SCTM No. 0103-010.00-01.00-022.000). (Co. Exec.) WAYS & MEANS



- Unlisted Action 1230. Authorizing the sale of County-owned real property pursuant to Section 72-h of the General Municipal Law to the Town of Brookhaven for Affordable Housing Purpose (SCTM No. 0200-069.00-08.00-007.001). (Co. Exec.) GOVERNMENT OPERATIONS, PERSONNEL, HOUSING & CONSUMER PROTECTION
- Unlisted Action 1231. Sale of County-owned real estate pursuant to Section 72-h of the General Municipal Law - Town of Brookhaven (SCTM No. 0200-256.00-05.00-037.000). (Co. Exec.) WAYS & MEANS
- Type II Action  
6 NYCRR 617.5(c)  
(20)(27) 1232. Authorizing the granting of a permanent easement to the Suffolk County Water Authority for production, distribution and transmission of drinking water on a parcel acquired by the County of Suffolk under the Old Drinking Water Protection Program – (Aldrich Lane, Mattituck New York bearing SCTM No. 1000-125.00-01.00-001.000). (Co. Exec.) ENVIRONMENT, PLANNING AND AGRICULTURE
- Type II Action  
6 NYCRR 617.5(c)  
(20)(27) 1233. Directing the Department of Social Services to implement an Emergency Housing Policy that will benefit homeless children. (Gregory) HUMAN SERVICES
- Type II Action  
6 NYCRR 617.5(c)  
(20)(25)(27) 1234. Appropriating funds in connection with the acquisition of a Suffolk County Telephony Structural Improvements (CP 1814). (Co. Exec.) \*\*WITHDRAWN AS OF 3/18/2013\*\*
- Type II Action  
6 NYCRR 617.5(c)  
(20)(25)(27) 1235. Appropriating funds in connection with the acquisition of an IFMS Release 3 (CP 1782). (Co. Exec.) EDUCATION AND INFORMATION TECHNOLOGY
- Type II Action  
6 NYCRR 617.5(c)  
(20)(25)(27) 1236. Appropriating funds in connection with the acquisition of a Disaster Recovery Project (CP 1729). (Co. Exec.) EDUCATION AND INFORMATION TECHNOLOGY
- Type II Action  
6 NYCRR 617.5(c)  
(20)(25)(27) 1237. Appropriating funds in connection with the acquisition of Fiber Cabling Network and WAN Technology Upgrades (CP 1726). (Co. Exec.) EDUCATION AND INFORMATION TECHNOLOGY
- Type II Action  
6 NYCRR 617.5(c)  
(20)(25)(27) 1238. Appropriating funds in connection with the acquisition and implementation of a District Attorney Case Management System (CP 1136). (Co. Exec.) \*\*WITHDRAWN AS OF 3/18/2013\*\*
- Type II Action  
6 NYCRR 617.5(c)  
(2)(20)(25)(27) 1239. Appropriating funds in connection with the replacement of existing Fireworks Burn Pits (CP 3016). (Co. Exec.) \*\*WITHDRAWN AS OF 3/18/2013\*\*
- Type II Action  
6 NYCRR 617.5(c)  
(20)(25)(27) 1240. Appropriating funds in connection with the purchase of heavy duty vehicles for the Police Department (CP 3135). (Co. Exec.) PUBLIC SAFETY
- Type II Action  
6 NYCRR 617.5(c)  
(20)(25)(27) 1241. Appropriating funds in connection with the purchase of Marine Bureau Diesel Engines (CP 3198). (Co. Exec.) PUBLIC SAFETY
- Type II Action  
6 NYCRR 617.5(c)  
(20)(25)(27) 1242. Appropriating funds in connection with the replacement of Police Headquarters 911 Backup Generator (CP 3216). (Co. Exec.) \*\*WITHDRAWN AS OF 3/18/2013\*\*

- Type II Action  
6 NYCRR 617.5(c)  
(2)(20)(27) 1243. Appropriating funds in connection with the replacement of existing shower facilities in the Police Emergency Services Section Building (CP 3232). (Co. Exec.) PUBLIC SAFETY
- Type II Action  
6 NYCRR 617.5(c)  
(20)(27) 1244. Amending the Operating Budget of the Department of Civil Service/Human Resources to add two Clerk Typist positions. (Co. Exec.) GOVERNMENT OPERATIONS, PERSONNEL, HOUSING & CONSUMER PROTECTION
- Type II Action  
6 NYCRR 617.5(c)  
(20)(27) 1245. Accepting and appropriating 100% Federal funds awarded by the U.S. Marshals Service to the Suffolk County Department of Probation and authorizing the County Executive to execute related agreements. (Co. Exec.) PUBLIC SAFETY
- Type II Action  
6 NYCRR 617.5(c)  
(20)(27) 1246. Accepting and appropriating 100% Federal funds awarded as pass-thru funding by the New York State Division of Criminal Justice Services to the Suffolk County Department of Probation and authorizing the County Executive to execute related agreements. (Co. Exec.) PUBLIC SAFETY
- Type II Action  
6 NYCRR 617.5(c)  
(20)(27) 1247. Confirming appointment of County Director of Probation (Patrice Dlhopsky). (Co. Exec.) PUBLIC SAFETY
- Type II Action  
6 NYCRR 617.5(c)  
(20)(27) 1248. Clarifying rules for distribution of public safety revenue sharing monies to towns and villages. (Schneiderman) PUBLIC SAFETY
- SEORA previously completed by Town 1249. Bond Resolution of the County of Suffolk, New York, authorizing the issuance of \$313,000 in bonds to finance the cost of infrastructure improvements under the Suffolk County Affordable Housing Opportunities Program (Summerwind Square – Riverhead) (CP 6411). (Co. Exec.) GOVERNMENT OPERATIONS, PERSONNEL, HOUSING & CONSUMER PROTECTION
- Type II Action  
6 NYCRR 617.5(c)  
(20)(27) 1250. Adopting Local Law No. -2013, A Local Law to enhance and improve Suffolk County's E-911 Service. (Kennedy) PUBLIC SAFETY
- Type II Action  
6 NYCRR 617.5(c)  
(20)(27) 1251. Amending the 2013 Adopted Operating Budget to transfer funding from Brentwood Union Free School District (UFSD) and the Town of Islip-ACCESS/ACCESSO programs to various agencies for the provision of chemical dependency services. (Co. Exec.) HEALTH
- Type II Action  
6 NYCRR 617.5(c)  
(20)(27) 1252. Authorizing transfer of property to the Department of Parks, Recreation and Conservation. (Kennedy) WAYS & MEANS
- Type II Action  
6 NYCRR 617.5(c)  
(20)(27) 1253. Establishing an Educational Outreach Program on the economic value of Cultural Arts. (Hahn) ECONOMIC DEVELOPMENT AND ENERGY
- Type II Action  
6 NYCRR 617.5(c)  
(20)(27) 1254. Amending Chapter 1070 of the Code of Suffolk County for Real Estate appraisal, acquisition and disposition, and implementing the "Triple A" acquisition procedure. (Co. Exec.) WAYS & MEANS
- Type II Action  
6 NYCRR 617.5(c)  
(20)(27) 1255. Terminating the County's contract with CMS Compliance Group. (Muratore) HEALTH

**PROCEDURAL MOTION**

Type II Action  
6 NYCRR 617.5(c)  
(20)(27)

PM07.

To renew agreement with PFM Asset Management LLC. (Pres. Off.) PARKS & RECREATION